

Wireless home automation

With coviva, you can transform existing electrical installations into a smart home without any construction work or cable routing.

Simply combine coviva's micromodules with a smartbox and the coviva app to create a smart home that's easy to install, monitor and control.



coviva smartbox	17.2
Micromodules	17.3
Remote controls and transmitters	17.6
Wireless control solutions for renovation	17.8
KNX wireless system platform	17.10
sepio alarm system	17.16
Fire alarm	17.33
Technical guide	17.36



TKP100A

coviva smartbox

Operating voltage:	5V=
Power consumption:	< 3 W
Transmission frequency:	868...870/433...434 MHz
Receiver category:	2
Transmitter duty cycle:	0.1...10%
Wireless range (open air):	300m
Network connection --> LAN:	at least Cat.5e-shielded
Network connection WLAN (optional):	802.11 b/g/n
USB port (only suitable for TKH180):	5 V=/250 mA in each case
Protection class, protection type:	II, IP30/IK04
Operating temperature :	0...40 °C
Storage temperature:	-25...70 °C
Relative humidity without condensation:	93% at 40°C
Dimensions (W x H x D):	178.5 x 156 x 48.4 mm

Delivery scope:

- coviva smartbox, adapter plate for optional wall mounting, RJ45 connection cable Cat.5e, power supply unit 230 V AC/5 V DC
- for visualising and controlling quicklink installations via an app.
- for Apple and Android smartphones
- coviva smartbox can only be commissioned with a myHager account as a registered electrician
- with 3 LEDs on the rear side (operation, WLAN and online) and one status RGB LED in the upper recess

Design

Cat. ref.

coviva smartbox

TKP100A



TKH180

USB stick for coviva

Operating voltage:	5V=
Current consumption:	max. 250 mA

- USB stick can be inserted to the side or rear of the coviva smartbox, depending on the installation
- WLAN connection of the coviva smartbox is only possible with the USB stick TKH180

Design

Cat. ref.

WIFI USB stick for coviva smartbox

TKH180

Robust and reliable, Hager's micromodules are compatible with all devices on the market. They enable lighting and powered opening/closing systems to be controlled remotely with the addition of wireless control points, so there will be no works or damage to your interior decoration.



Linked to coviva, they ensure remote and local control by smartphone or tablet. quicklink designates the set-up mode without any tools by using the buttons found on the products.



- Lighting functions
- On/Off (switch)
 - On
 - Off
 - On/Off (switch)
 - On/Off dimming
 - ON dimming '+'
 - OFF, dimming '-'
 - Timer
 - Scene setting

TRM693G:
This module is particularly appropriate for any type of lighting control, including CFL and LED.

- Rolling shutter functions
- Raise
 - Lower
 - Scene setting
 - Raise / lower (switch)
 - Force raise
 - Force lower
 - Repetition

Automatic recognition of the type of command (switch or push button) Paired On/Off switch inputs benefit from this function.

Repeater function
All products powered by mains are repeaters, boosting the signal.

Micromodule 2 battery inputs

- lithium battery powered CR 2430 3 V
 - LED powered
 - dimensions (H x L x D): 41 x 39.5 x 11 mm
 - 2 inputs for potential-free contacts
 - All types of command
- raise / lower
 - start / stop
 - scene setting
 - etc.

Description
light grey

Cat. ref.
TRM702A



TRM702A

Micromodules for controlling lighting ON/OFF without neutral (2 wires)

- dimensions (H x L x D): 40 x 40 x 18 mm
- 1 x 200 W 230 V output without neutral (incandescent, halogen BT, halogen TBT, dimmable LED) and 2 inputs for potential-free contacts

Description
light grey

Cat. ref.
TRM690G



TRM690G

Micromodules for controlling lighting ON/OFF dimming without neutral (2 wires)

- dimensions (H x L x D): 40 x 40 x 18 mm
- 1 x 200 W output without neutral (incandescent, halogen BT, halogen TBT, dimmable LED) and 2 inputs for potential-free contacts

Description
light grey

Cat. ref.
TRM691E



TRM691E

Micromodules for controlling lighting ON/OFF with neutral (3 wires)

- dimensions (H x L x D): 40 x 40 x 20 mm
- 1 x 3 A 230 V output with neutral with zero crossing switch, 2 inputs for potential-free contacts. Suitable for all kinds of lamps.

Description
light grey

Cat. ref.
TRM693G



TRM693G



TRM692G

**Micromodule for controlling rolling shutters / awnings
rolling shutters 4 wires**

(↑, ↓, Ph, N)
- dimensions (H × L × D): 40 × 40 × 18 mm
1 × 3 A 230 V output for 1 230 V motor
2 inputs for potential-free contacts
TRM692G inputs are pre-configured ↑ / ↓
for switches to be linked

Description

light grey

Cat. ref.

TRM692G



TRM694G

Micromodule multifunction

for controlling:
- garage doors, gates
- automatic pulse control
- door release
- SELV output
- dimensions (H × L × D): 40 × 40 × 20 mm

1 × 4 A potential-free output
2 inputs for potential-free contacts

Description

light grey

Cat. ref.

TRM694G

Simple configuration in 3 steps



01 Once the switch is connected to the emitter, start the configuration by pressing **cfg** button and then the button on the switch.



02 Select the function on the output (1 function = 1 color pattern). Validate by a long press > 2s until the LED blinks.

03 Exit configuration mode by a short press on **cfg** button on the emitter.

1 color pattern = 1 function

LED colour	On/Off Receivers	Dimmers	Shutters/Blinds
	Function	Function	Function
	on off On/Off (Toggle Switch)	On/Off Dimming +/-	Up/Stop (TRM692G only)
	on ON	+ ON (Dimming +)	Up, Stop
	off OFF	- OFF (Dimming -)	Down, Stop
	1 Scenario 1	1 Scenario 1	1 Scenario 1
	2 Scenario 2	2 Scenario 2	2 Scenario 2
	Timer	Timer	Down, Stop
	On/Off (Switch)	On/Off (Switch)	Shutter Control (Switch)
	on Priority ON		Priority UP
	off Priority OFF		Priority DOWN
	Clear	Clear	Clear

*functions only available on TRMxxx

Wireless transmitters enable control points to be easily added increased without any wiring or creating any mess. The TU444 remote control enables a tebis and/or wireless/mixed system to be controlled.

quicklink designates the configuration mode without any tools by using the buttons on the products.

Characteristics

- unidirectional transmitters in use and bidirectional in configuration
- frequency: 868.3 MHz wireless KNX
- low battery indication
- average battery lifetime: 5 years
- range: 100 m minimum in open field and through 2 concrete slabs

Take care with unused inputs; do not cut the wires and do not remove the insulation sleeves.

* according to the installation/assembly conditions



TRM600

Micromodule for remote controlled switches and timers

Enables a wireless control point to be added to an existing remote controlled or timer switch circuit.
- dimensions (H x L x D): 40 x 40 x 18 mm

Generates a pulse contact lasting 200 minutes
Connects behind a push-button in the existing circuit.

Description	Cat. ref.
white	TRM600



TU418

Remote controls wireless KNX

- equipped with CR 2430
- 3 V battery

Description	Cat. ref.
2 buttons	TU402
4 buttons	TU404
6 buttons	TU406
6 buttons - 18 channels	TU418



TRC301B

Wireless magnetic opening contact sensor

- 2 x LR03 batteries supplied

Description	Cat. ref.
white	TRC301B



D8931

Wireless magnetic opening contact sensor

To be connected with TRC301B NC contact (magnetic)

Description	Cat. ref.
surface-mounted terminal block - white	D8924
universally protected - 1 m cable - white	D8931



TRC321B

Wireless light sensor with suction

For controlling shutters (sun protection, light-sensitive switch function)
- suction cell

- fibre-optic
- 1.5 m cable

Description	Cat. ref.
white	TRC321B

KNX wireless wall-transmitter 1 or 2 gang flat quicklink

For wireless remote control of all assigned KNX wireless receivers.

Operating voltage:	5V=
Power consumption:	< 3 W
Transmission frequency:	868...870/433...434 MHz
Receiver category:	2
Transmitter duty cycle:	0.1...10%
Wireless range (open air):	300m
Network connection --> LAN:	at least Cat.5e-shielded
Network connection WLAN (optional):	802.11 b/g/n
USB port (only suitable for TKH180):	5 V=/250 mA in each case
Protection class, protection type:	II, IP30/IK04
Operating temperature :	0...40 °C
Storage temperature:	-25...70 °C
Relative humidity without condensation:	93% at 40°C
Dimensions (W x H x D):	178.5 x 156 x 48.4 mm

KNX Functions available

- reset functions
- functions : Switching , Dimming , Blinds, 2 scenes, Time switching, NO contact push button
- integration in KNX wireless/TP gateway
- surface mounted
- ETS additional functions
- with led configuration
- with push button configuration
- toolless configuration
- delivered with battery 3V type CR 2430

KNX wireless wall transmitter 1 gang flat solar quicklink

Description	Cat. ref.
Berker S.1/B.3/B.7	
white glossy	8565 51 82
polar white glossy	8565 51 89
polar white matt	8565 51 88
anthracite matt	8565 51 85
aluminium, matt, lacquered	8565 51 83
Berker R.1/R.3	
polar white glossy	8565 51 39
black glossy	8565 51 31

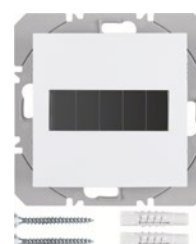

KNX wireless wall transmitter 2 gang solar quicklink

Description	Cat. ref.
Berker S.1/B.3/B.7	
white glossy	8565 61 82
polar white glossy	8565 61 89
polar white matt	8565 61 88
anthracite matt	8565 61 85
aluminium, matt, lacquered	8565 61 83
Berker R.1/R.3	
polar white glossy	8565 61 39
black glossy	8565 61 31



KNX wireless wall-transmitter 1-gang flat quicklink

Characteristics



85655289



Operating voltage	3 V=
Battery service life	≈ 5 years
Wireless transmission frequency	868.3 MHz
Wireless protocol	KNX Wireless
Transmitter duty cycle	1 %
Receiver category	2
Number of wireless channels	2
Number of quicklink links	max. 20 transmitter/receiver
Wireless transmission power	< 10 mW
Wireless transmission range (free field)	max. 100 m
Wireless transmission range (building)	max. 30 m
Operating temperature	-5 ... +45 °C
Assembling height	14 mm

For wireless remote control of all assigned KNX wireless receivers.

- reset function (to factory setting)-
- quicklink functions: switching, dimming, blind, 2 scenes, time switching, NO contact push-button, memory
- integration in the KNX wireless/TP gateway, surface-mounted, into the KNX TP system
- ETS additional functions: +6 scenes, operating mode on/off, push-button, status display, dimming value
- with configuration LED
- with transmission status and battery status LED, red/green/orange
- with configuration button
- operating areas configurable as one or two-area operation
- with anti-dismantling protection
- with lithium coin cell battery 3 V type: CR 2430
- top and bottom operating area are freely configurable
- toolless quicklink configuration using buttons and LED display
- for flat surface mounting and extension of combinations



85655289

Design	Order no.	PU
Berker S.1/B.3/B.7		
white glossy	8565 52 82	1
polar white glossy	8565 52 89	1
polar white matt	8565 52 88	1
anthracite matt	8565 52 85	1
aluminium, matt, lacquered	8565 52 83	1

Berker Q.1/Q.3

white velvety	8565 52 22	1
polar white velvety	8565 52 29	1
anthracite velvety, lacquered	8565 52 26	1
aluminium velvety, lacquered	8565 52 24	1

Berker K.1/K.5

polar white glossy	8565 52 79	1
anthracite matt, lacquered	8565 52 75	1
aluminium, matt, lacquered	8565 52 77	1
stainless steel matt, lacquered	8565 52 73	1

Berker R.1/R.3

polar white glossy ¹⁾	8565 52 39	1
black glossy ¹⁾	8565 52 31	1



KNX wireless wall-transmitter 2-gang flat quicklink

Operating voltage	3 V=
Battery service life	≈ 5 years
Wireless transmission frequency	868.3 MHz
Wireless protocol	KNX Wireless
Transmitter duty cycle	1 %
Receiver category	2
Number of wireless channels	4
Number of quicklink links	max. 20 transmitter/receiver
Wireless transmission power	< 10mW
Wireless transmission range (free field)	max. 100 m
Wireless transmission range (building)	max. 30 m
Operating temperature	-5 ... +45 °C
Assembling height	14 mm

For wireless remote control of all assigned KNX wireless receivers.

Characteristics

- reset function (to factory setting)-
- quicklink functions: switching, dimming, blind, 2 scenes, time switching, NO contact push-button, memory
- integration in the KNX wireless/TP gateway, surface-mounted, into the KNX TP system
- ETS additional functions: +6 scenes, operating mode on/off, push-button, status display, dimming value
- with configuration LED
- with transmission status and battery status LED, red/green/orange
- with configuration button
- operating areas configurable as one or two-area operation
- with anti-dismantling protection
- with lithium coin cell battery 3 V type: CR 2430
- top and bottom operating area are freely configurable
- toolless quicklink configuration using buttons and LED display
- for flat surface mounting and extension of combinations



Design	Order no.	PU
Berker S.1/B.3/B.7		
white glossy	8565 62 82	1
polar white glossy	8565 62 89	1
polar white matt	8565 62 88	1
anthracite matt	8565 62 85	1
aluminium, matt, lacquered	8565 62 83	1
Berker Q.1/Q.3		
white velvety	8565 62 22	1
polar white velvety	8565 62 29	1
anthracite velvety, lacquered	8565 62 26	1
aluminium velvety, lacquered	8565 62 24	1
Berker K.1/K.5		
polar white glossy	8565 62 79	1
anthracite matt, lacquered	8565 62 75	1
aluminium, matt, lacquered	8565 62 77	1
stainless steel matt, lacquered	8565 62 73	1
Berker R.1/R.3		
polar white glossy ¹⁾	8565 62 39	1
black glossy ¹⁾	8565 62 31	1



Wireless wall sensor

Can be affixed in an area 'without mains' and controlled by a 230 V wireless receptor with resistive 10 A dry contact.

Characteristics

- available in battery or solar version
- detection angle: 220°
- IP55 / IK04
- unidirectional transmitters in use and bidirectional in configuration
- frequency: 868.3 MHz wireless KNX
- range: 100 m in open field
- equipped with 3 × 1.5 V batteries

Wireless KNX receivers

act as power interfaces for controlling electronic receivers.

Characteristics

- bi-directional receivers
- frequency: 868.3 MHz wireless KNX

Lighting functions

- ON/OFF (switch)
- ON
- OFF
- ON/OFF (switch)
- timer
- forced mode ON
- forced mode OFF

Rolling shutter functions

- raise
- lower
- scene setting
- raise / lower (switch)
- force raise
- force lower



TRE520

Wireless wallmounted KNX infra-red movement sensors

Description

Cat. ref.

Battery transmitter pack + 1 10 A contact receiver

white

TRE700

Battery transmitter

white

TRE520

anthracite

TRE521

Solar transmitter

white

TRE530

anthracite

TRE531



TRE302

Wireless KNX IP55 switches

Possibility of connecting disconnected potential-free contacts

Description

Cat. ref.

1 button 1 input

TRE301

2 buttons 2 inputs

TRE302



TRB302B

Recessed input module KNX wireless

Description

Cat. ref.

2 inputs 230V supply for 2 volt-free input contacts

TRB302B



TRB201

ON/OFF receiver, to be flush-mounted, wireless KNX

- 1 ON/OFF output 16 A / 230 V AC1

Description

Cat. ref.

light grey

TRB201



TRE600

LED projector with movement sensor

60 W LED lamp (300 W halogen equivalent)

- 220 / 360° detection angle
- energy class A
- 5700 K
- 3400 lumen

Description

Cat. ref.

white

TRE600

ON/OFF wireless KNX projected IP55 receivers

Dimensions 150 × 85 × 35 mm

Description

1 × 10 A / 230 V AC1 output (potential-free)

2 × 10 A / 230 V AC1 outputs (potential-free)

Cat. ref.

TRE201

TRE202



TRE201

IP55 wireless projected KNX rolling shutter/blind receiver

Dimensions 150 × 85 × 35 mm

- 1 output voltage / blind raising / lowering

4 wires (↑, ↓, Ph, N)

10 A / 230 V AC1

Description

white

Cat. ref.

TRE221



TRE221

1 input + 1 output IP55 projected wireless KNX receiver

- 1 input 1 potential-free contact

- 1 × 10 A / 230 V AC1 output (potential-free)

Description

white

Cat. ref.

TRE400



TRE400

Motion detector kit IP55 KNX wireless

includes:

- 1 × TRE520 motion detector

- 1 × TRE201 wall mounted output

Description

motion detector kit

Cat. ref.

TRE720



TRE720

KNX wireless switch activator for plugs

- for remote-controlled switching of electrical loads

Description

KNX wireless switch activator

Cat. ref.

TRC270D



TRC270D

KNX wireless System Platform

Hager KNX wireless is a very versatile system. This is because its electronic platform masters both conventional applications and wireless solutions, in a very simple way. As it is a bidirectional wireless system, even existing KNX systems can be extended simply. Also, it is just as easy to install and assign functions and components via quicklink.

Common features

- 230 V, 50/60 Hz, +10/-15 % Low power consumption: < 0.1 W or < 0.3 W
- New PEIS AM/PM interface : better isolation and guiding SW and HW coding PM/AM recognition

- Claws (isolated) with larger opening Anti-theft-solution for all AMs (not for Berker R.x)
- Screw terminals with harder screws
- Uniform, high-value metal ring Mostly slim models (22 mm)

KNX wireless Dimmer

Replace the switch, insert the dimmer: Never before has it been this easy to combine increased lighting comfort with low energy consumption. As the first dimmer of its kind, the KNX wireless universal touch dimmer can control almost all dimmable light sources, from LED and energy-saving lamps through incandescent lamps through to halogen lighting, both reliably and without flickering.



Relay insert

230 V retrofit LED lamps	440W	- parallel compensated	1000W
Dimmable energy saving lamps	440W	- in Duo circuit	1000W
Fluorescent lamps:		- with electronic ballast (EB)	1000W
- uncompensated	1100VA		
Description			Cat. ref.
light grey			8512 12 00



Switch insert 1 gang

230 V incandescent lamps and halogen lamps	25..400W	Dimmable energy saving lamps	13..80W
Dimmable 230 V retrofit LED lamps	5..70W	Dimmable conventional transformers	25..400VA
		Electronic transformers and dual mode transformers	25..400W
Description			Cat. ref.
light grey			8512 11 00



Switch insert 2 gang

230 V incandescent lamps and halogen lamps	35..300W	Dimmable energy saving lamps	15..54W
Dimmable 230 V retrofit LED lamps	12..54W	Dimmable conventional transformers	35..300VA
		Electronic transformers and dual mode transformers	35..300W
Description			Cat. ref.
light grey			8512 22 00



Touch dimmer (R, L)

230 V incandescent lamps and halogen lamps	25..400W	Dimmable conventional transformers	35..300VA
		Number of universal capacity enhancers	max.2
Description			Cat. ref.
light grey			8542 11 00



Universal touch dimmer 1 gang

230 V incandescent lamps and halogen lamps	25..400W	Dimmable energy saving lamps	13..80W
Dimmable 230 V retrofit LED lamps	5..70W	Dimmable conventional transformers	25..400VA
		Electronic transformers and dual mode transformers	25..400W
Description			Cat. ref.
light grey			8542 12 00



Universal touch dimmer 2 gang

230 V incandescent lamps and halogen lamps	35..300W	Dimmable energy saving lamps	15..54W
Dimmable 230 V retrofit LED lamps	12..40W	Dimmable conventional transformers	35..300VA
		Electronic transformers and dual mode transformers	35..300W
Description			Cat. ref.
light grey			8542 21 00

Characteristics

Wireless transmission/reception frequency	868.3MHz	quicklink functions: switching, dimming, blind, 2 scenes, time switching, NO contact pushbutton, memory
Wireless protocol:	KNX protocol	
Wireless transmission range (free field)	100m	
Wireless transmission range (building)	30m	
Operating temperature	-5...+45°C	

Wireless button 1 gang quicklink

Suitable for	Order no.	Page
Relay insert	8512 12 00	17.10
Switch insert 1gang	8512 11 00	17.10
Touch dimmer (R, L)	8542 11 00	17.10
Universal touch dimmer 1gang	8512 12 00	17.10
Mains insert for KNX radio application module	8502 01 00	-

Description

Cat. ref.

Berker S.1 | B.3 | B.7

white glossy	8514 51 82
polar white glossy	8514 51 89
polar white matt	8514 51 88
anthracite matt	8514 51 85
aluminium, matt, lacquered	8514 51 83

Berker Q.1 | Q.3 | Q.7

white velvety	8514 51 22
polar white velvety	8514 51 29
anthracite velvety, lacquered	8514 51 26
aluminium velvety, lacquered	8514 51 24

Berker K.1 | K.5

polar white glossy	8514 51 79
anthracite matt, lacquered	8514 51 75
aluminium matt, lacquered	8514 51 77
stainless steel matt, lacquered	8514 51 73

Berker R.1/R.3

polar white glossy	8514 51 39
black glossy	8514 51 31

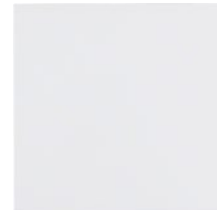



Wireless button 2 gang quicklink

Suitable for	Order no.	Page
Switch insert 2gang	8512 22 00	17.10
Universal touch dimmer 2gang	8542 21 00	17.10
Mains insert for KNX radio application module	8502 01 00	-

Description Cat. ref.

Berker S.1/B.3/B.7

white glossy	8514 61 82
polar white glossy	8514 61 89
polar white matt	8514 61 88
anthracite matt	8514 61 85
aluminium, matt, lacquered	8514 61 83

Berker Q.1 | Q.3 | Q.7

white velvety	8514 61 22
polar white velvety	8514 61 29
anthracite velvety, lacquered	8514 61 26
aluminium velvety, lacquered	8514 61 24

Berker K.1 | K.5

polar white glossy	8514 61 79
anthracite matt, lacquered	8514 61 75
aluminium matt, lacquered	8514 61 77
stainless steel matt, lacquered	8514 61 73

Berker R.1/R.3

polar white glossy	8514 61 39
black glossy	8514 61 31

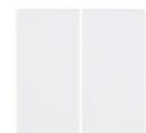

Wireless button 4 gang quicklink

Suitable for	Order no.	Page
Switch insert		17.10
Dimmer insert		17.10
Mains insert for KNX radio application module	8502 01 00	-

Description Cat. ref.

Berker S.1/B.3/B.7

white glossy	8564 81 82
polar white glossy	8564 81 89
polar white matt	8564 81 88
anthracite matt	8564 81 85
aluminium, matt, lacquered	8564 81 83

Berker Q.1 | Q.3 | Q.7

white velvety	8564 81 22
polar white velvety	8564 81 29
anthracite velvety, lacquered	8564 81 26
aluminium velvety, lacquered	8564 81 24

Berker K.1 | K.5

polar white glossy	8564 81 79
anthracite matt, lacquered	8564 81 75
aluminium matt, lacquered	8564 81 77
stainless steel matt, lacquered	8564 81 73

Berker R.1/R.3

polar white glossy	8564 81 39
black glossy	8564 81 31



KNX wireless timer quicklink

Description	Cat. ref.	Suitable for	Order no.	Page
		Relay insert	8512 12 00	17.10
		Mains insert for KNX radio application module	8502 01 00	-
Berker S.1/B.3/B.7				
white glossy			8574 52 82	
polar white glossy			8574 52 89	
polar white matt			8574 52 88	
anthracite matt			8574 52 85	
aluminium, matt, lacquered			8574 52 83	
Berker Q.1 Q.3 Q.7				
white velvety			8574 52 22	
polar white velvety			8574 52 29	
anthracite velvety, lacquered			8574 52 26	
aluminium velvety, lacquered			8574 52 24	
Berker K.1 K.5				
polar white glossy			8574 52 79	
anthracite matt, lacquered			8574 52 75	
aluminium matt, lacquered			8574 52 77	
stainless steel matt, lacquered			8574 52 73	
Berker R.1/R.3				
polar white glossy			8574 52 39	
black glossy			8574 52 31	



KNX wireless motion detector comfort 1.1m quicklink

Description	Cat. ref.	Suitable for	Order no.	Page
		Relay insert	8512 12 00	17.10
		Mains insert for KNX radio application module	8502 01 00	-
Berker S.1/B.3/B.7				
white glossy			8534 51 82	
polar white glossy			8534 51 89	
polar white matt			8534 51 88	
anthracite matt			8534 51 85	
aluminium, matt, lacquered			8534 51 83	
Berker Q.1 Q.3 Q.7				
white velvety			8534 51 22	
polar white velvety			8534 51 29	
anthracite velvety, lacquered			8534 51 26	
aluminium velvety, lacquered			8534 51 24	
Berker K.1 K.5				
polar white glossy			8534 51 79	
anthracite matt, lacquered			8534 51 75	
aluminium matt, lacquered			8534 51 77	
stainless steel matt, lacquered			8534 51 73	
Berker R.1/R.3				
polar white glossy			8534 51 39	
black glossy			8534 51 31	





KNX wireless motion detector comfort 2.2m quicklink

Suitable for	Order no.	Page
Relay insert	8512 12 00	17.10
Mains insert for KNX radio application module	8502 01 00	-

Description Cat. ref.

Berker S.1/B.3/B.7

white glossy	8534 61 82
polar white glossy	8534 61 89
polar white matt	8534 61 88
anthracite matt	8534 61 85
aluminium, matt, lacquered	8534 61 83

Berker Q.1 | Q.3 | Q.7

white velvety	8534 61 22
polar white velvety	8534 61 29
anthracite velvety, lacquered	8534 61 26
aluminium velvety, lacquered	8534 61 24

Berker K.1 | K.5

polar white glossy	8534 61 79
anthracite matt, lacquered	8534 61 75
aluminium matt, lacquered	8534 61 77
stainless steel matt, lacquered	8534 61 73

Berker R.1/R.3

polar white glossy	8534 61 39
black glossy	8534 61 31

Blind insert Comfort

Description

black glossy

Cat. ref.

8522 11 00

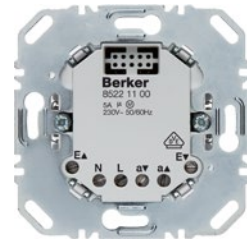

Blind insert comfort

Suitable for

Blind insert comfort
Mains insert for KNX radio application module

Optional

KNX radio brightness sensor

Order no.

8522 11 00
8502 01 00

Page

17.15
-

Description

Berker S.1/B.3/B.7

white glossy	8524 51 82
polar white glossy	8524 51 89
polar white matt	8524 51 88
anthracite matt	8524 51 85
aluminium, matt, lacquered	8524 51 83

Berker Q.1 | Q.3 | Q.7

white velvety	8524 51 22
polar white velvety	8524 51 29
anthracite velvety, lacquered	8524 51 26
aluminium velvety, lacquered	8524 51 24

Berker K.1 | K.5

polar white glossy	8524 51 79
anthracite matt, lacquered	8524 51 75
aluminium matt, lacquered	8524 51 77
stainless steel matt, lacquered	8524 51 73

Berker R.1/R.3

polar white glossy	8524 51 39
black glossy	8524 51 31

Cat. ref.

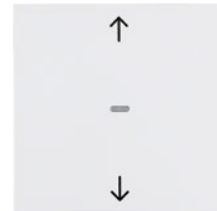

sepio control panel

- sepio wireless system is suitable for retrofitting of residential and small commercial premises.
- sepio is more than just an alarm. Thanks to its connection with your smartphones, it is even more user-friendly, interactive and effective. You can keep in contact with your home, and remotely visualise what is happening there at any moment of the day, or in case of any event detected.
- it features:
 - voice assistance with feedback for installation and use
 - progressive deterrence to dissuade intruders before break-in
 - several steps progressive deterrence with outdoor detector
 - control panel
 - compatible with then old LS range
 - extended connectivity PSTN/GSM/ADSL
 - multi-operator SIM card ensuring the best network availability
 - local and remote devices control

sepio alarm pack

- starter pack to secure housing



RLC304F

Wireless alarm control panel LS, 4 groups

Power supply	RXU05X power pack (4.5V / 14 Ah) RXU01X 200-240 V AC	- control panels manage: intrusion protection, protection of individuals, fire alarm and household protection
Battery life	5 years in normal conditions of use	- adapted for residential and small tertiary premises
Average current consumed	235µA	- can control up to 4 separate protection groups
Operating temperature	-10°C to 55°C	- speech synthesis (6 languages)
Degree of mechanical protection	IP30 / IK06	- 4 customizable command keys and 12 programming keys
Siren acoustic power	100 (±2) dB(A) at 1m	- status change signal light
Dimensions	232 x 232 x 67.7mm	- vocal personalisation of the detectors (max. 40)
Weight	1200g	- log of the last 500 dates and time-stamped events
Central siren with integrated command keypad allowing to parameter and use sepio alarm system.		- 4-step progressive deterrence, with outdoor detector and outdoor siren emitting strobe flashes
		- control can be operated from: remote, keypad with or without badge reader and with or without display, with or without voice synthesis, smartphone

Description
white

Cat. ref.

RLC304F



RLP305F

Security pack, 4 groups

- 1 wireless alarm control panel 4 groups RLC304F
- 2 remote controls, 4 functions info feedback RLF444X
- 2 wireless expert pet tolerant motion detectors S165-22F
- 1 outdoor vocal siren white/orange

Description

wireless alarm pack, 4 groups

Cat. ref.

RLP305F

seprio commands

Remote controls

- ensure wireless control of the alarm system functionalities, as well as lighting and shutters. They allow to locally or remotely send alerts through the system: alert, silent alert, fire alert, audible call.

Alarm pendant

- allow to send emergency call 24h a day, might the system be turned on or off. Waterproof, it can be used indoor or outdoor and works under the shower. It can be worn as a pendant, on a belt or fixed on the wall thanks to the cord and clip.

Keypads

- command keypad ensures the control of the alarm system functionalities and the management of code or badge access through Twinband® wireless.
- screen vocal keypad makes the installation easier and the use more convenient by confirming all control acknowledgment and signaling any potential anomaly or open door.

4 inputs wireless remote control

- 4 programmable keys wireless / hybrid alarm
- 4 programmable keys alarm / quicklink
- supply: 2 x batteries 3 V type CR2430 (included)

Description

blue

Cat. ref.

TU444



TU444



quicklink

Alarm pendant

2 programmable commands

- slider ("alert" command)
- button ("alert" or "comfort" command, 10 years autonomy (1 call per day) and delivered with cord and clip)

Description

white

Cat. ref.

RLF001X



RLF001X



Command keypad

Power supply	4.5V / 2.7Ah battery pack
Battery life	3 years in normal conditions of use
Average current consumed	90µA
Operating temperature	-10°C to 55°C
Degree of mechanical protection	IP30
Dimensions	194 x 95 x 19mm
Weight	270g (with power pack)

Each command is confirmed with an audible signal and a visual signal (LED) issued by the keypad. The keypad also indicates the system status and any faults or open doors or windows.

- 4 personalisable keys
- code-based access to keypad commands
- alarm command functions
- 3-colour LED to support use and programming



RLF620X



The command and information keypad can be used to operate an intrusion protection system from inside the home.

Description

white

Cat. ref.

RLF620X



RLF660X



Screen vocal keypad with tag

Power supply	4.5V / 2.7Ah battery pack	- access codes		
Battery life	5 years in normal conditions of use	- tag reader (identification of up to 32 tags)		
Average current consumed	45µA	- 4 keys (2 pre-programmed, and 2 menu keys whose functions depend on what is displayed on the screen)		
Operating temperature	-10°C to 55°C	- touch screen zone for display navigation		
Degree of mechanical protection	IP30	- speech synthesis and OLED screen		
Dimensions	194 x 95 x 19mm	Suitable for	Order no.	Page
Weight	220g (with power pack)	Tags	RLF1..X	17.18

The vocal keypad with tag reader and screen can be used to operate an intrusion protection system from inside the home.

Description	Cat. ref.
white	RLF660X



RLF444X



4-function remote control with information feedback

Power supply	lithium battery 3V / 270mA/h CR2430	- access codes		
Battery life	5 years in normal conditions of use	- tag reader (identification of up to 32 tags)		
Average current consumed	45µA	- 4 keys (2 pre-programmed, and 2 menu keys whose functions depend on what is displayed on the screen)		
Operating temperature	-10°C to 55°C	- touch screen zone for display navigation		
Degree of mechanical protection	IP30	- speech synthesis and OLED screen		
Dimensions	194 x 95 x 19mm			
Weight	220g			

Description	Cat. ref.
white	RLF444X



RLF101X



Tag for access management

	Suitable for	Order no.	Page
	Keypad	RLF660X	17.18
Description	Pack qty.	Cat. ref.	
orange	1	RLF101X	
orange	10	RLF110X	

Intrusion detection

Motion detectors

- ensure volumetric protection of the premises. They can detect any moving heat source, such as infrared radiation emitted by the human body. The "expert pet tolerant" feature allows to distinguish pets, and therefore enhance efficiency by avoiding any false alarm triggering. The bi-technology detector is particularly adapted to premises with high temperature variation. It combines 2 detection types (heat source and moving objects) to trigger intrusion alert.

Detector-camera with sending pictures

- ensure housing monitoring and, in case of break-in, trigger the alarm and capture, store or remotely transmit a sequence of images. It distinguishes the presence of human from pet and features an integrated flash light allowing to take pictures even in low lighting level.

Wireless motion detector

- 1 alimentation réf. BATLi38 fournie*

Description	Pack qty.	Cat. ref.
wireless motion detector, 90°, 12 m	1	S161-22F
wireless corridor detector, 22 m	1	S162-22X
wireless curtain detector, 12 m	1	S163-22X
wireless expert pet tolerant motion detector, 85°, 12 m	1	S165-22X



S161-22F



Pet-tolerant IR detector-camera with sending pictures

Power supply	lithium battery 4.5V / 3Ah	Fitted with a specific lens and able to record image sequences using its built-in camera, the PIR motion detector with image transmission detects intrusion in rooms at risk in the home and is able to distinguish between the presence of a human being and that of a pet (cat, dog).
Detection angle	90°	
Detection range	12m	
Operating temperature	0°C to +55°C	
Degree of mechanical protection	IP31	Following infrared detection, the motion detector triggers the alerts and deterrents and records a sequence of images. These can then be:
Dimensions	125 x 85 x 67mm	- Stored on the microSD card (supplied)
Weight	205g	- Remotely transmitted via a dialler/transmission module GSM/GPRS(MMS)



RLA176X



Description	Pack qty.	Cat. ref.
pet-tolerant IR detector-camera with sending pictures	1	RLA176X

Outdoor anti-masking detector

Power supply	lithium battery 3.6V / 4Ah	- detects intrusion before break-in
Detection angle	180°	- anti-masking protection: detects any fraudulent masking of the front face 24/24
Detection range	5 setting levels from 2.5 to 12m	- 6 ready-to-use area mask sets supplied to adapt detection area
Operating temperature	-20°C to +60°C	
Degree of mechanical protection	IP55	
Dimensions	71 x 186 x 106mm	
Weight	540g	



RLA144X



Description	Pack qty.	Cat. ref.
outdoor anti-masking detector	1	RLA144X

IP55 detectors

- suitable for use in tough environment (garage, hangar, outdoor protection in pre-alarm mode, ...)

Outdoor detectors

- adapted for outdoor, even in tough environment, they are used for perimeter and premise protection from outside. Ideal to protect a door, a garage, a hangar or a facade. They feature the "expert pet tolerant" function and are adapted for an outdoor use.

Door and window detector

- ensures the protection of the doors and the windows of the premises. When any opening is detected, it triggers an alert.



S145-22X



Outdoor motion detector 2 x 12m

Power supply	lithium battery 3.6V / 4Ah	- for indoor / outdoor use
Detection range	12m	
Operating temperature	-20°C to +50°C	
Degree of mechanical protection	IP55	
Dimensions	56 x 128 x 235mm	
Weight	596g	

Description

outdoor motion detector 2 x 12m

Cat. ref.

S145-22X



S121-22X



Wireless dual technology motion detector

Power supply	lithium battery 2 x (3.6V / 2Ah)	- dual technology: infrared and hyperfrequency
Detection angle	90°	
Detection range	12m	
Operating temperature	-10°C to +55°C	
Degree of mechanical protection	IP31	
Dimensions	125 x 75 x 65mm	
Weight	208g	

Description

wireless dual technology motion detector

Cat. ref.

S121-22X



S261-22F



Wireless door and window detector

Power supply	lithium battery 3V / 1Ah	- for indoor use
Operating temperature	-10°C to +55°C	
Degree of mechanical protection	IP31	
Dimensions	108 x 26 x 30mm	
Weight	60g	

The contact detector is used to protect openings such as doors & windows. It is fitted with a built-in magnetic contact (reed switch).

Description

white
brown

Pack qty.

1
1

Cat. ref.

S261-22F
S262-22F

Multicontact detector

- ensures the protection of the doors and the windows of the premises. When any opening is detected, it triggers an alert. Its wired terminal allows the connection of additional wired contact detectors (standard contact, wide spacing, garage door contact,...)

External universal transmitter

- allows :
 - wireless ON/OFF control from a dry contact (timer, tebis automation output module,...)
 - wired detector information reporting (IR barrier, wide spacing contact,...)

Multicontact detector

Power supply lithium battery 3.6V / 1Ah - for indoor use
 Operating temperature -10°C to +55°C
 Degree of mechanical protection IP31
 Dimensions 138 x 26 x 30mm
 Weight 70g



S271-22F

Description	Pack qty.	Cat. ref.
white	1	S271-22F
brown	1	S272-22F



External universal transmitter

Power supply lithium battery 2 x (3.6V / 2Ah) - for outdoor use
 Operating temperature -25°C to +70°C
 Degree of mechanical protection IP55
 Dimensions 130 x 80 x 35mm
 Weight 200g



S230-22X

Description	Pack qty.	Cat. ref.
white	1	S230-22X



sepio household protection

Detector for roller blinds

- detects the opening of a closed blind. When the blind is raised by a few centimeters, the detector triggers an alert.

Glassbreak detector

- specially adapted to bay windows protection in housings. it detects sounds vibration emitted by glass breaking and triggers an alert.

Technical detectors

- allows detection of different types of risks in housings or premises, such as:
 - prolonged power cut of a device or a housing
 - flood or critical water level in an installation
 - frost protection temperature threshold in a room
 - temperature threshold in a freezer to avoid device malfunction
 - smoke spillage due to an outbreak of fire

In case an incident is detected, the siren of the alarm system will emit audible beeps every 10 seconds during 3 minutes or until the conditions are back to normal.
A specific message is sent when the alert is remotely triggered.



S231-22X



Detector for roller blinds

Power supply	lithium battery 3.6V / 1Ah	- for indoor application
Operating temperature	-10°C to +55°C	
Degree of mechanical protection	IP31	
Dimensions	138 x 26 x 30mm	
Weight	70g	

Description	Pack qty.	Cat. ref.
white	1	S231-22X
brown	1	S236-22X



S280-22X



Glassbreak detector

Power supply	lithium battery 2 x (3.6V / 2Ah)	- for indoor application
Operating temperature	-10°C to +55°C	
Degree of mechanical protection	IP31	
Dimensions	138 x 40 x 30mm	
Weight	90g	

Description	Pack qty.	Cat. ref.
white	1	S280-22X



S232-22X



Freezer breakdown detector

Power supply	lithium battery 2 x (3.6V / 2Ah)
--------------	----------------------------------

Description	Pack qty.	Cat. ref.
white	1	S232-22X

Loss of mains supply detector

Power supply lithium battery 2 x (3.6V / 2Ah)

Description	Pack qty.	Cat. ref.
white	1	S233-22X



S233-22X



Frost detector

Power supply lithium battery 2 x (3.6V / 2Ah)

Description	Pack qty.	Cat. ref.
white	1	S234-22X



S234-22X



Flood detector

Power supply lithium battery 2 x (3.6V / 2Ah)

Description	Pack qty.	Cat. ref.
white	1	S235-22X



S235-22X



Technical probes

Description	Pack qty.	Cat. ref.
freezer breakdown	1	SONPC
mains power failure	1	SONCS
freezing	1	SONHG
flooding	1	SONIN



SONPC



Smoke and heat detectors

- trigger a specific sound modulation on the sirens, and an emergency lighting on the detector itself. It is possible to stop the detector tone by pressing the test button or any button of an infrared remote (TV, DVD reader, HiFi,...) without any prior programming.

- Smoke detector is complying to EN 14 604 : 2005 + AC 2008 certified
- NF492 par AFNOR Certification
- The technical detectors are permanently active, whatever the status of the control panel (activated or deactivated).



S155-22X



Smoke detector

Power supply	sealed lithium battery 2x3V	- for indoor application
Battery life	10 years	
Detection signal	85dB at 3m	
Operating temperature	-10°C to +65°C	
Degree of mechanical protection	IP22	
Dimensions	Ø116 x 49mm	
Weight	255g	

Description	Pack qty.	Cat. ref.
white	1	S155-22X



S157-22X



Heat detector

Power supply	sealed lithium battery 2x3V	- for indoor application
Battery life	10 years	
Detection signal	85dB at 3m	
Operating temperature	-10°C to +65°C	
Degree of mechanical protection	IP22	
Dimensions	Ø116 x 49mm	
Weight	255g	

Description	Pack qty.	Cat. ref.
white	1	S157-22X

Receivers

- allows to control a light in ON/OFF or time-delay mode, or an automatic gate or garage door in pulse mode. They can simulate a presence when associated with a keyboard. When associated with the control panel, allows to activate a light of a bright flash in case of an intrusion, but also indicates a report on the system status.

- depending on the status and events of the 2 systems, different life scenarios will be possible. The integration, in domovea, of the alarm functionalities is also possible, allowing to locally or remotely (from a PC, tablet or smartphone) act on the alarm system, or receive notifications in case of intrusion, anomaly or alert, for example.

Alarm interface

- is a bidirectional communication gateway allowing the link between tebis system (KNX and/or domovea) and wireless or mixt. The interface allows a perfect interaction between the 2 systems.

Wireless command receiver

- ensures the transmission of Twinband wireless messages between different system components while increasing their wireless operating range. It is also possible to equip wide areas where wireless transmission could be difficult.

External receiver

Operating temperature -20°C to +70°C - for indoor or outdoor application
 Degree of mechanical protection IP55
 Dimensions 150 x 85 x 35mm
 Weight 224g

Possible applications: on/off, time lag, presence simulation (when associated to keypad), remote control, impulse mode, system status reporting, activation in case of intrusion.



S781-22X



Description	Pack qty.	Cat. ref.
230V	1	S781-22X
12 - 24V	1	S791-22X

Alarm interface

Power supply 30V DC via KNX bus - for indoor application
 Operating temperature 0°C to +45°C
 Degree of mechanical protection IP30
 Dimensions 203 x 77 x 26.5mm
 Weight 140g

The TRC120 interface is used to enable Hager intrusion alarm system to communicate with the KNX world. On the alarm side, the interface communicates with the alarm central unit by wireless and by TP bus on the KNX side.



TRC120



Description	Pack qty.	Cat. ref.
white	1	TRC120

Relais sans fil

Power supply battery MPU01X - for indoor or outdoor (in sheltered location) application
 Operating temperature -25°C to +70°C
 Degree of mechanical protection IP54
 Dimensions 245 x 215 x 120mm
 Weight 880g

The receiver makes it possible to:

- interface a hardwired alarm product or any other low voltage automatic pulsed control device with the alarm system,
- operate additional deterrence devices (smoke generator, lighting, etc.) and other electrical devices (low voltage or power)



RLE700X



Description	Pack qty.	Cat. ref.
white	1	RLE700X

Transmitter

- The transmitter or plug-in module PSTN + GSM / GPRS allows, when an intruder or technical alarm is triggered, to remotely warn or alert by sending pre-recorded messages to several contacts, on their fixed-line or mobile phone.
- are a way to remove the doubt: listening and calling out (PSTN or GSM), transmission of the images captured by the detector through MMS (via GSM network with MMS option) to the private and films through ViewCom-IP to the monitoring station.

- They also allow to send by SMS via a system corresponding number informations about SMS consumption or SIM card validity, and by MMS the first 5 images captured by the detection alarm (via a detector-camera with sending pictures).



RLD464F



PSTN + GSM/GPRS stand-alone transmitter

Power supply	battery	Power supply:
Battery life	5 years in normal conditions of use	- (4.5 V, 14 Ah) RXU05X power pack - low voltage threshold standard Type C - low threshold 3.65 V
Average current consumed	235µA	- or (4.5 V, 14 Ah) RXU05X power pack backed up by (3.7 V 1.3 Ah) RXU03X Li-Ion buffer battery
Operating temperature	-10°C to +55°C	- or (200-240 VAC 50-60 Hz / 4.5 V DC 2.2 A) RXU01X internal mains power module backed up by (3.7 V/1.3 V) RXU03X Li-Ion buffer battery
Degree of mechanical protection	IP30	- Low voltage threshold Type A - 3.6V - recharge time 20 hours to 80% - Duration with back-up: 36 h.
Dimensions	216 x 237 x 67mm	
Weight	1070g	

The RLD464F dialler operates with the Hager Twinband® alarm system.

It is suitable for specific configurations when a plug-in module cannot be directly added to the control panel.

The RLD464F dialler is recommended for complete extended and redundant transmission in voice mode (analogical) via PSTN with GSM back-up.

Description	Pack qty.	Cat. ref.
white	1	RLD464F



RLD454F



PSTN + GSM / GPRS plug-in module

Power supply	battery	Power supply:
Battery life	5 years in normal conditions of use	- (4.5 V, 14 Ah) RXU05X power pack - low voltage threshold standard Type C - low threshold 3.65 V
Average current consumed	235µA	- or (4.5 V, 14 Ah) RXU05X power pack backed up by (3.7 V 1.3 Ah) RXU03X Li-Ion buffer battery
Operating temperature	-10°C to +55°C	- or (200-240 VAC 50-60 Hz / 4.5 VDC 2.2 A) RXU01X internal mains power module backed up by (3.7 V / 1.3 V) RXU03X Li-Ion buffer battery -
Degree of mechanical protection	IP30	- Low voltage threshold Type A - 3.6 V - recharge time 20 hours to 80% - Duration with back-up: 36 h.
Dimensions	165 x 63 x 35mm	
Weight	114g	

The RLD454F plug-in module operates with the Hager Twinband® alarm system.

It can be fitted to the control panel as an optional device.

The RLD454F module is recommended for complete extended and redundant transmission in voice mode (analogical) via PSTN with GSM back-up.

Description	Pack qty.	Cat. ref.
white	1	RLD454F

Sirens

- ensure alert function with modulations programmable from the control panel, for outdoor and indoor operation. A special modulation in case of fire is also available for alerts sent from fire or heat detector. Reinforced deterrence thanks to an outdoor detector which features audible, voice and light functions to dissuade intruder before break-in, or gradually reacts as the intruder approaches.

Indoor siren with vocal notification

Power supply	lithium battery 2 x (3.6V / 13Ah)
Battery life	5 years in normal conditions of use
Acoustic level	93 (± 2) dB
Operating temperature	-10°C to +55°C
Degree of mechanical protection	IP31
Dimensions	178 x 191 x 61mm
Weight	900g

The indoor siren provides audible information and ensures intruder deterrence when an alarm is triggered.

It sounds loudly in the event of intrusion, fire, audible warnings or household faults and issues vocal notifications about the system status.

It can be used as a door chime.



RLD414X



Description	Pack qty.	Cat. ref.
indoor siren with vocal notification	1	RLD414X

Outdoor siren with orange flash

Power supply	battery 6V / 14 Ah RXU06X	- for outdoor use
Battery life	5 years in normal conditions of use	
Acoustic level	103 (± 2) dB	
Operating temperature	-25°C to +70°C	
Degree of mechanical protection	IP54	
Dimensions	235 x 256 x 90mm	
Weight	2500g	

In addition to the protection provided by the control panel with built-in siren and keypad, the outdoor siren deters intruders.

In the event of intrusion, the siren is immediately triggered and sounds loudly for 90 seconds.

If a fire is detected, the siren is triggered in fire sounding mode for 5 min.

If somebody attempts to pull the siren off the wall, it sounds and then triggers all the alerts and deterrents via the control panel.

Thanks to its built-in transmitter, the siren notifies the control panel of battery faults, the radio link status and the tamper pin status.



RLD415F



Description	Pack qty.	Cat. ref.
outdoor vocal siren with orange flash	1	RLD415F
outdoor vocal siren white with orange flash	1	RLD416X



RLD416X

Glass break detector test unit

- is recommended to test if the detector is working correctly as well as the coverage area.



RXA02X

Replacement belt clip

Description	Pack qty.	Cat. ref.
replacement belt clip	1	RXA02X



RLH001X

Memory card multilingual

- 6 languages
- configuration, parameters and voice messages backup
- allows control panel change without reprogramming
- transfer of voice messages to a separated transmitter

- groups and transmission module backup

Suitable for	Order no.	Page
Control panel	RLC304F	17.16

Description	Pack qty.	Cat. ref.
memory card multilingual	1	RLH001X



856-99X

Multi socket RJ11 / RJ45-RJ45

- with RJ45 nesting plug and RJ11 socket

Description	Pack qty.	Cat. ref.
multi socket RJ11 / RJ45-RJ45	1	856-99X



900-99X

ADSL master filter

Description	Pack qty.	Cat. ref.
ADSL master filter	1	900-99X



RXA03X

GSM antenna

- adhesive
- external antenna

Suitable for	Order no.	Page
PSTN + GSM/GPRS stand-alone transmitter	RLD464F	17.26
PSTN + GSM/GPRS plug-in module	RLD454F	17.26

Description	Pack qty.	Cat. ref.
GSM antenna	1	RXA03X

MicroSD memory card

Description	Pack qty.	Cat. ref.
microSD memory card	1	RXE00X

Suitable for
Pet-tolerant IR detector-camera

Order no.
RLA176X

Page
17.19



RXE00X

Smoke detector tester

- no SFC, safe for human health and environment, content 150 ml
- please observe the conditions of use mentioned in the users instructions

Description	Pack qty.	Cat. ref.
smoke detector tester	1	TESTFUM



TESTFUM

Glass break detector test unit

- MN1604 supply unit included

Description	Pack qty.	Cat. ref.
glass break detector test unit	1	TV260



TV260

Mains power supply module

- mains power supply: 200-240V AC - 50/60Hz / 4.5V DC 2.2A

Suitable for
Control panel
PSTN + GSM/GPRS stand-alone transmitter
optional
Secondary battery

Order no.
RLC304F
RLD464F
RXU03X

Page
17.16
17.26
17.31

Description	Pack qty.	Cat. ref.
mains power supply module	1	RXU01X



RXU01X



RLH002X

1 wired input / 2 relay outputs module

Allows to connect the following components to the control panel:

- auto-powered wired siren
- alarm system (flash, voice module,...)
- recording system (recording controller, video recorder)

Suitable for
Control panel

Order no.
RLC304F

Page
17.16

Description	Pack qty.	Cat. ref.
1 wired input / 2 relay outputs module	1	RLH002X



RXA05X



Connecting socket with relay (230V)

- 1NO/1NC contact 230V (AC or DC)

Suitable for
Smoke detector
Heat detector

Order no.
S155-22X
S157-22X

Page
17.24
17.24

Description	Pack qty.	Cat. ref.
connecting socket with relay (230V)	1	RXA05X

Battery pack, 4.5V / 2.7Ah

Suitable for	Order no.	Page
Command keypad	RLF620X	17.17
Screen vocal keypad	RLF660X	17.18

Description	Pack qty.	Cat. ref.
battery pack, 4.5V / 2.7Ah	1	RXU04X



RXU04X

Secondary battery Li-Ion, 3.7V / Ah

- for GSM/GPRS use, with or without power supply

Description	Pack qty.	Cat. ref.
secondary battery Li-Ion, 3.7V / Ah	1	RXU03X



RXU03X

Battery pack, 4.5V / 15Ah

Suitable for	Order no.	Page
Control panel	RLC304F	17.16
PSTN + GSM/GPRS stand-alone transmitter	RLD464F	17.26

Description	Pack qty.	Cat. ref.
battery pack, 4.5V / 15Ah	1	RXU05X



RXU05X

Battery pack, 6V / 15Ah

Suitable for	Order no.	Page
Outdoor siren with orange flash	RLD415F	17.27

Description	Pack qty.	Cat. ref.
battery pack, 6V / 15Ah	1	RXU06X



RXU06X



BATLi01

Batteries

Description	Cat. ref.
lithium battery 3,6 V / 5 Ah	BATLi01
lithium battery 7,2 V / 13 Ah	BATLi02
lithium battery 6 V	BATLi03
lithium battery 3,6 V / 2 Ah	BATLi04
lithium battery 3,6 V / 4 Ah	BATLi05
lithium battery 7,2 V / 5 Ah	BATLi06
lithium battery 3 V type 2016	BATLi07
lithium battery 3 V type 2430	BATLi08
lithium battery 3 V type 2032	BATLi09
lithium battery 9 V	BATLi10
lithium battery 7,2 V / 13 Ah	BATLi22
lithium battery 2 x 3,6 V / 36 Ah	BATLi23
lithium battery 2 x 3,6 V / 4 Ah	BATLi26
lithium battery 4,5 V / 3 Ah	BATLi30
lithium battery 3 V / 1 Ah	BATLi31
lithium battery 3,6 V / 2 Ah	BATLi38
battery kit 9 V	MN1604



BATLi11

Other batteries

Description	Cat. ref.
rechargeable lithium-ion battery	BATLi11
secondary battery 3,6 V / 700 mAh GSM	908-21X
battery for outdoor siren 2 Ah	BATPB2



851-99X

Cordons of phone connecting

Description	Cat. ref.
cordons of phone connecting with stacked-shelving grip and RJ11	851-99X
multi-socket RJ11 / RJ45-RJ45	856-99X

Stand alone smoke detectors

- are dedicated to fire protection in housings. Equipped with optical technology, they are particularly adapted to detect slow growth fire.
- functions: fault indication when the detector head is dirty or not working, possibility to deactivate the detector for about 15 minutes, active 24 hours a day.

Stand alone heat detectors

- are complementary to smoke detectors, as they can be installed in rooms such as kitchen, where there can be cooking smoke. It detects when a temperature increases abnormally fast to reach 54 to 70°C.
- Functions: fault indication when the detector head is dirty or not working, possibility to deactivate the detector for about 15 minutes, active 24 hours a day.

Stand alone smoke detectors

Average coverage	50 m ²
Use	indoor
Power supply	TG600A: replaceable CR123A type 3 V lithium battery; 5-year battery life TG600AL: non-replaceable CR17335 type 3 V lithium battery
Operating temperature	- 10°C to + 65°C
Storage temperature	- 20°C to + 45°C
Degree of protection	IP30
Dimensions (D x H)	97 mm x 37 mm
Weight (with battery)	55 g

The optical smoke detector is designed to protect the private areas of apartment buildings, residential properties and mobile homes.

If smoke is detected, the detector's red LED flashes rapidly and modulated sounding is triggered (85 dB(A) at 3 m).



TG600A

Description	Pack qty.	Cat. ref.
stand alone smoke detector 5 years	1	TG600A
stand alone smoke detector 10 years	1	TG600AL

Stand alone smoke and heat detectors

Power supply	sealed lithium battery 2x3V	- for indoor application
Battery life	10 years	
Detection signal	85dB at 3m	
Operating temperature	-10°C to +65°C	
Degree of mechanical protection	IP22	
Dimensions	Ø116 x 49mm	
Weight	255g	



S155-22X

Description	Pack qty.	Cat. ref.
standalone smoke detector	1	S155-22X
standalone heat detector	1	S157-22X

Smoke detector tester

- no SFC, safe for human health and environment, content 150 ml
- please observe the conditions of use mentioned in the users instructions

Description	Pack qty.	Cat. ref.
smoke detector tester	1	TESTFUM



TESTFUM

It is possible to configure virtually any function in push-button mode – i.e. using the buttons on the devices themselves. Each transmitter is equipped with a configuration button (cfg) and each receiver is equipped with a configuration button and a function button (cfg + fct) for this purpose. All of the functions are indicated by coloured LEDs, whereby the fct button can be used to simply “scroll through” them.

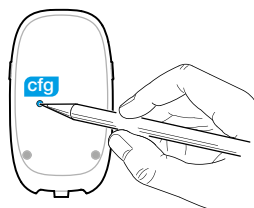

1. Activating configuration mode

Briefly press the cfg button on the transmitter. The cfg LEDs on the transmitter and all receivers light up.



2. Configuring the transmitter

Briefly press the channel button to which a function is to be assigned on the transmitter. The cfg LED on the transmitter flashes for 1 second. Transmitter and receiver are now in configuration mode.

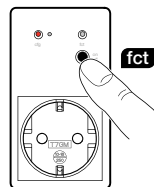

3. Selecting a function

Press the fct button on the receiver repeatedly until the chosen function is indicated by the fct LED.

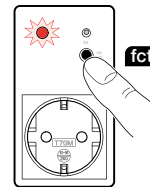

4. Confirming the selected function

Press the fct button on the receiver and keep it pressed for > 2 s until the cfg LED starts flashing to confirm the selected function. To configure a group control system, repeat steps 3 and 4 on all other receivers in the group.

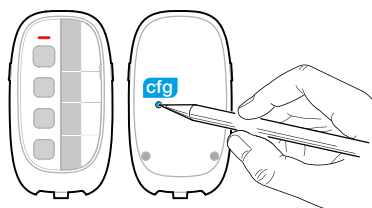

5. Terminating configuration

Briefly press the cfg button on the transmitter again. The cfg LEDs on the transmitter and all receivers go out. The configuration process really is “quick”!

LED colour	Switching outputs	Dimmers	Shutters/Blind outputs
	Function	Function	Function
	on ON/OFF (one surface control element)	ON/OFF Dimming +/-	
	on ON	+ ON (Dimming +)	Opening, Stop
	off OFF	- OFF (Dimming -)	Closing, Stop
	Scenario 1	Scenario 1	Scenario 1
	Scenario 2	Scenario 2	Scenario 2
	Timer	Timer	
	ON/OFF (Switch)	On/Off (Switch)	Shutter Control, system (Switch)
	on Priority ON		Priority OPEN
	off Priority OFF		Priority CLOSE
	Clear	Clear	Clear

**Flush-mounted radio input module, 2-gang, 230 V, quicklink
TRB302B**

	TRB302B
Power supply	230V AC, 50 Hz ± 15%
Inputs	2 for floating contacts
Contact current	30 µA
Input current	19 mA
Transmit frequency	868.3 MHz
Range - indoors - outdoors	Max. 30 m Max. 100 m
Operating temperature	0 °C to +45 °C
Storage temperature	-20 °C to +70 °C
Ingress protection rating	IP20
Dimensions H x W x D	48 mm x 53 mm x 27 mm
Connection	Plug-in connector, connecting wires 200 mm long

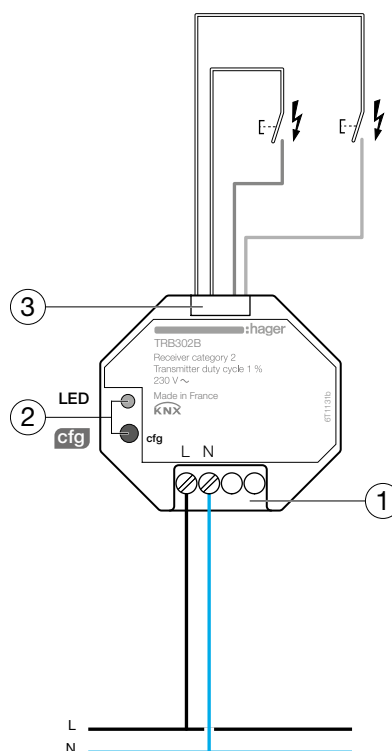

- ① Terminal strip for the power supply
- ② Configuration button and LED **cfg**
- ③ Plug-in connector with connecting wires for the inputs (20 cm long)

**Wireless plug adapter actuator, quicklink
TRC270D**

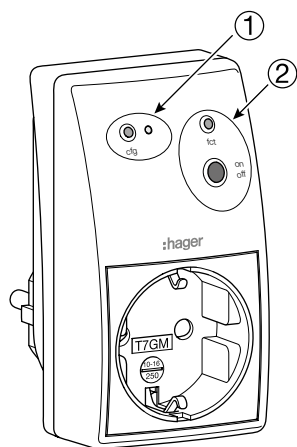

- ① Configuration button and LED **cfg**
- ② Function button and LED **fct** for the output

**Surface-mounted radio tactile sensor, IP55, quicklink
TRE301/TRE302**

Technical data	
Power supply	2xCR 2430 3.0 V (TBTS, SELV, ZLVS)
Estimated service life of the battery	5 years
Transmit frequency	868.3 MHz
Range in open spaces	100 m
Dimensions	76 mm x 49 mm x 23 mm
Cable length	< 3 m
Minimum dwell period	50 ms
Ingress protection rating – with wires connected	IP55 IP31
Operating temperature	-10 °C ... +50 °C
Storage temperature	-20 °C ... +70 °C
Standards	EN 60950-1 / EN 301489-3 EN 300220-2 / EN 50491-3

Contact assignments for external inputs

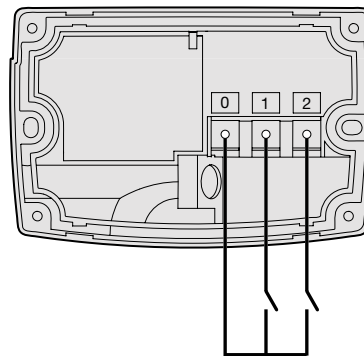

Installation

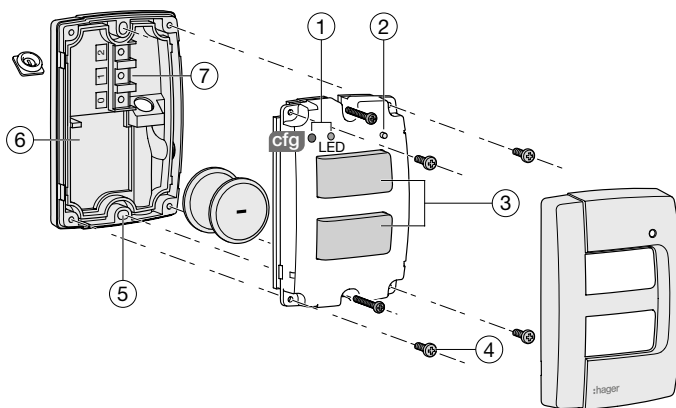

- ① The configuration button and LED **cfg** are located under the cover
- ② Transmission pilot light
- ③ Operator control buttons
- ④ Screw plugs for the battery compartment
- ⑤ Wall-mounting holes
- ⑥ Terminal strip holder
- ⑦ Terminal strip for external inputs

States indicated by the transmission pilot light ②

	State of the LED	Colour of the LED	Meaning
Activation of one of the buttons	Lights up briefly	Green	Transmitting the control command, input configured
	Flashes for 2 seconds	Green	Transmitting the control command, scene input (teach-in mode)
	Flashes for 1 second	Orange	Input not configured
	Flashes for 1 second	Red	Low battery charge
	Does not light up	-	- No batteries or very low charge - Batteries fitted the wrong way round

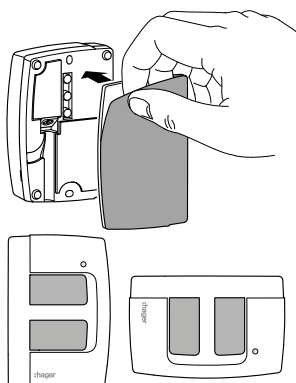

The device may be mounted to the wall with double-sided adhesive tape or screws. The following must be taken into consideration when using external inputs:

- Mounting orientation, i.e. horizontal or vertical alignment
- Supply line < 3 m

Flush-mounted radio switching output module quicklink TRB201 and socket quicklink TRC270D

	TRB201	TRC270D
Power supply	230V AC, 50 Hz ± 15%	
Outputs	μ 16 A 230V AC, AC1	μ 16 A 230V AC1 for resistive loads / μ 10 A 230 V AC1 for lamp loads
Type	NO contacts	
Switching capacity for:		
- Incandescent lamps	2300 W	2300 W
- 230 V halogen lamps	2300 W	2300 W
- LV halogen lamps with CTR	1600 VA	1600 VA
- LV halogen lamps with ETR	1200 VA	1200 VA
- Fluorescent lamps	20 × 36 W Max. 47 μF	20 × 36 W Max. 120 μF
Connection		
- flexible	1.5 - 2.5 mm ²	
- rigid	1.5 - 2.5 mm ²	
Transmit frequency	868.3 MHz	
Range		
- indoors	Max. 30 m	
- outdoors	Max. 100 m	
Operating temperature	0 °C to +45 °C	0 °C to +45 °C
Storage temperature	-20 °C to +70 °C	-20 °C to +70 °C
Ingress protection rating	IP20	IP30
Dimensions H x W x D	48 x 53 x 30 mm	98 x 40 (80) x 54 mm

CTR: conventional transformer
ETR: electronic transformer

Flush-mounted radio module, 1 output, quicklink TRB201

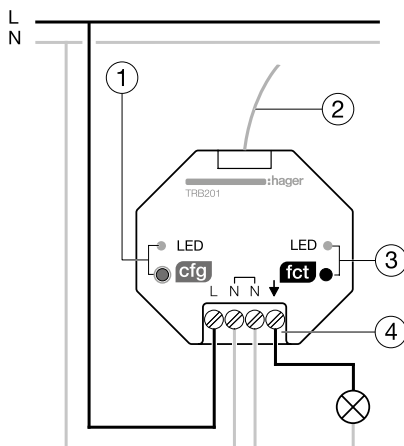





- ① Configuration button and LED **cfg**
- ② Radio transmitter
- ③ Function button and LED **fct** for the output
- ④ Terminal strip
 - L: Phase 230 V
 - N: Neutral
 - ↓: 230 V contact output

Technical data

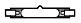
	TRE20x / TRE400
Power supply	230V DC +10–15%
Transmit frequency	868.3 MHz
Switching capacity per output	2 (μ 16 A 230V AC, AC1)
Ingress protection rating	IP55
Operating temperature	-10 °C ... +55 °C
Storage temperature	-20 °C ... +70 °C
Dimensions (H × W × D)	150 mm × 85 mm × 35 mm
Connection	0.75 mm ² to 2.5 mm ²

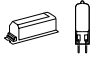
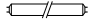
Maximum load per switching output

	230V AC	Incandescent lamps	1500 W
	230V AC	Halogen lamps	1500 W
	12V DC 24V DC	Conventional transformer	600 W
	12V DC 24V DC	Electronic transformer	600 W
	230V AC	Electronic transformer ballast	600 W
		Fluorescent lamps with ECG	6 x 58 W
		Fluorescent lamps with conventional ballast connected in parallel	-
		Energy-saving lamps	6 x 18 W

Connection

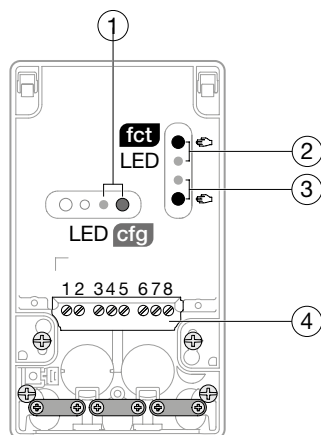

- ① Configuration button and LED **cfg**
- ② ③ Function buttons and LEDs **fct** for outputs S1 and S2
- ④ Terminal strip

Surface-mounted radio output modules, 1 output, IP55, quicklink TRE201

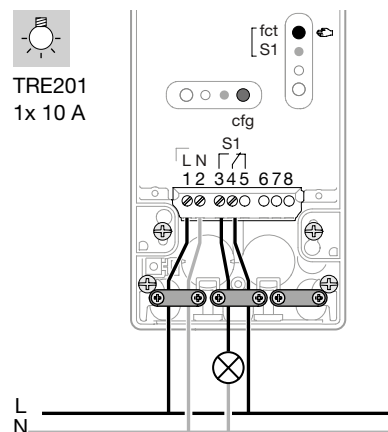

Surface-mounted radio output modules, 2 output IP55, quicklink TRE202

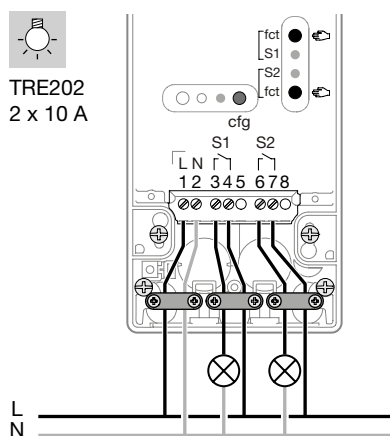

Surface-mounted radio module, 1 input + 1 output IP55, quicklink connection TRE400

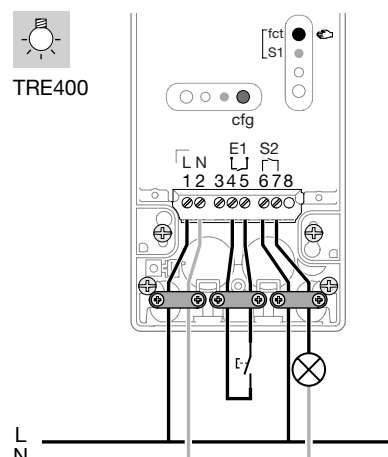

Surface-mounted radio blind output module, 1 output IP55, quicklink TRE221

	TRE221
Power supply	230V DC +10–15%
Transmit frequency	868.3 MHz
Delay time between 2 opposite directions	600 ms
Ingress protection rating	IP55
Operating temperature	–10 °C ... +55 °C
Storage temperature	–20 °C ... +70 °C
Dimensions (H × W × D)	150 mm × 85 mm × 35 mm
Standards	EN 60669-2-1 EN 301489-3 EN 300220-2 EN50491-3 EN50428

Connecting TRE221

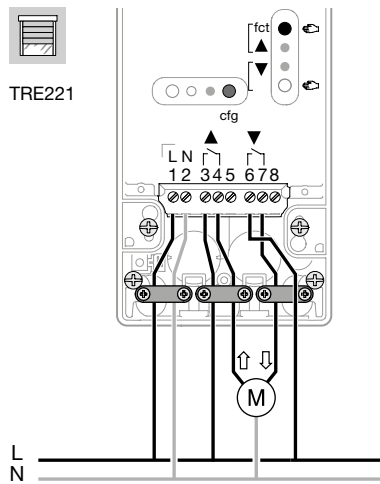

Surface-mounted radio motion detector, battery and solar-powered, IP55, quicklink TRE52x/TRE53x

Technical properties

	TRE52x (battery)	TRE53x (solar)	TRE600
Colour	white, anthracite	white, anthracite, alum., brown	white
Detection zone	220° + 360° 16 m to the front / 10 m to the side 360° detection: 6 m diameter under the sensor		120° + 360° 12 m to the front / 10 m to the side 360° detection: 6 m diameter under the sensor
Head adjustment (vertical)	+90°/-30°		-
Head adjustment (horizontal)	±80		
LED lamp adjustment	-		180° (horizontal) / 340° (vertical)
Masking panels	Supplied with the devices		
Corner bracket (inside/outside)	EE855 white; EE856 anthracite		-
Potentiometer brightness adjustment	5 to 1000 lux		
Time delay adjustment	30 s to 15 min		
Sensitivity adjustment	20 to 100%		
Transmit frequency	868.3 MHz		
Controlled by remote control	TU4xx		
Pilot light detection	Yes		
Power supply	3 × 1.5V AAA	Solar cell with back-up battery	230V AC
Range	100 m (open spaces)		
LED power			approx. 60 W (300 W white-hot)
Standards	EN 609 50-1 EN 301489-3 EN 300220-2 EN 50491-3		
Ingress protection rating	IP55		
IK code	04		
Ambient conditions	- Storage temperature -20 °C to +55 °C - Operating temperature -20 °C to +60 °C		
Dimensions (L × W × H)	153 mm × 91 mm × 130 mm		322 mm × 150 mm × 257 mm

Motion detector, quicklink TRE52x/TRE53x

Description

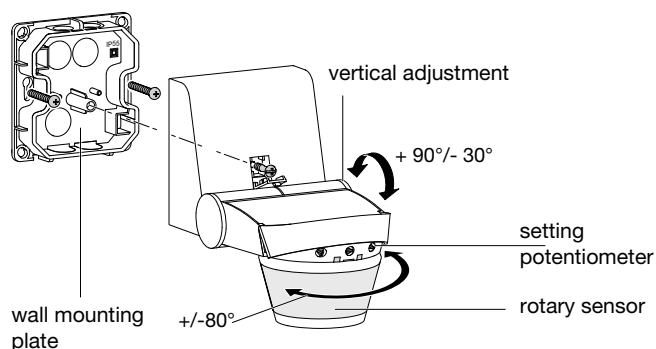

Detection range TRE52x/TRE53x

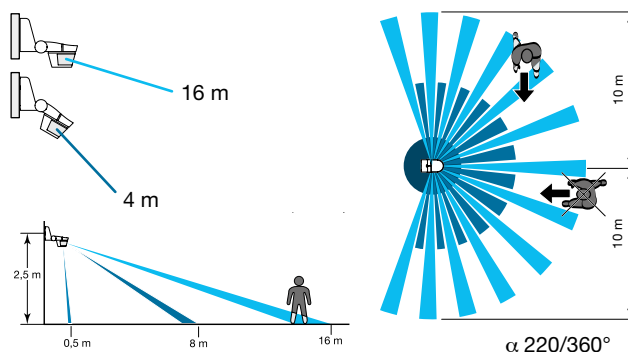

Recommended installation height 2,5 m.
The detection zone must be free of obstructions at all times.

Motion detector, quicklink TRE600

Description

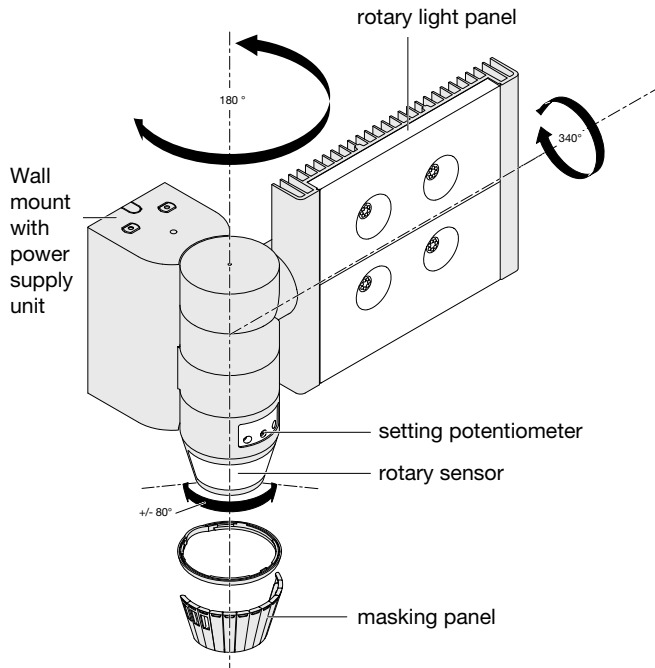

Detection range

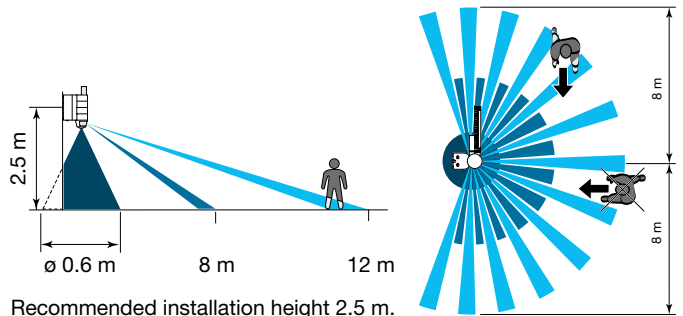

Recommended installation height 2.5 m.
The detection zone must be free of obstructions at all times.

Installation TRE52x/TRE53x

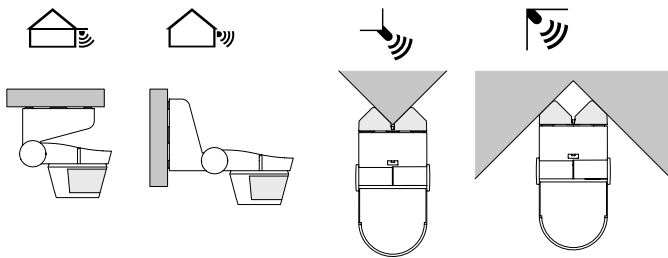

Corner adapter TRE52x/TRE53x

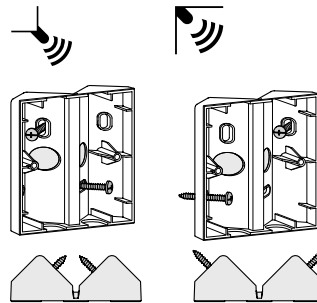

Masking panels TRE52x/TRE53x

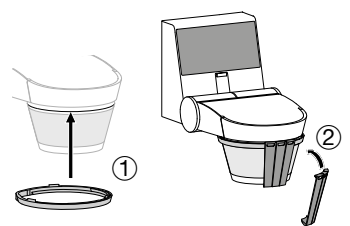

Installation TRE600

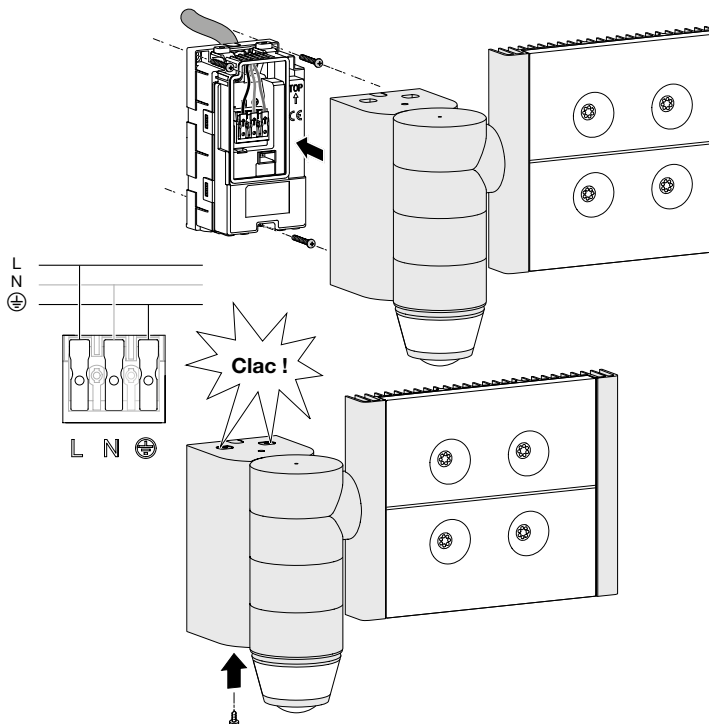

Surface mounted wireless motion detector IP55 quicklink

Device adjustments

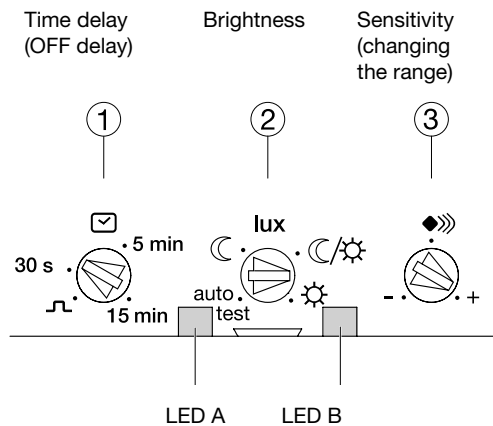

TRE5xx cfg button

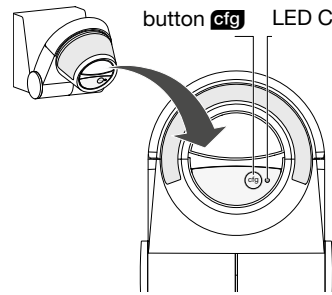

Fitting the batteries TRE52x

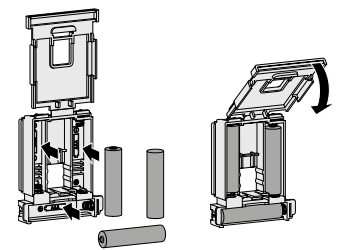

TRE600 cfg button

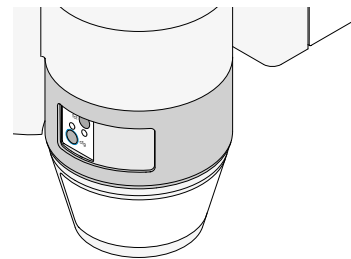

Device adjustments

Operation	Setting	Potentiometer
Light switched on automatically for a predetermined period of time according to standard settings (factory). This function is only available if the time delay has been programmed for the detector.	Automatic settings Set lux potentiometer to "auto-test". The default settings are as follows: Lux = ☾, (night mode only) period = 3 min Sensitivity = max.	
Light switched on automatically for a predetermined period of time. This function is only available if the time delay has been programmed for the detector.	Electrician settings	
Testing and confirming the detection range.	Test mode Set potentiometer 2 to "auto-test".	
Adjusting the sensitivity.	Used to set the range in order to prevent interference	
Adjusting the sensitivity.	Used to set the sensitivity in order to avoid perturbation.	

LED fct	Function
	on/off ON/OFF (staircase lighting circuit)
	on ON
	off OFF
	1 Scene 1
	2 Scene 2
	Time switch
	ON/OFF (switch)
	on Forced mode ON
	off Forced mode OFF
	Presence simulation
	Delete

seprio central panel

Reference	RLC304F
Power supply	- RXU05X power pack (4.5 V - 14 Ah) - Low voltage threshold Type C - 3.65 V - or RXU01X 200-240 VAC 50-60 Hz/4.5 VDC 2.2 mains power unit backed up by RXU03 Li-Ion 3.7 V 1.3 Ah battery - Low voltage threshold Type A - 3.6 V - Recharge time 10 hours to 80% - 36 hours battery life
Battery life	approx. 5 years in normal conditions of use
Average current consumed	235 µA
Average humidity rate	from 5 % to 75 % without condensation at 25° C
Wireless link	TwinBand®, 400/800 MHz
Control panel specifications	4 separate groups progressive deterrence protection of individuals 10 remote control units max. 40 intrusion detectors max. 5 deterrence devices max. 32 user codes - 5 radio repeater relays maximum - 3 diallers maximum (transmission module included) vocal personalisation of detectors (max. 40) system saved to S.I.T.E. NVM stick (optional) built-in command keypad built-in remote control operation (if transmission module installed) log of the last 500 dates and time-stamped events 2 hardwired outputs + 1 hardwired input (optional)
Operating temperature	- 10°C to + 55°C
Degree of mechanical protection	IP 30 / IK 06
Tamper protection	opening / removal / line cuts (if transmission module is installed) / attempts to discover radio codes / radio interference
Supervision	wireless power pack / mains power module / battery Li-Ion tamper
Siren acoustic power	100 (±2) dB(A) average at 1 m
Audible alarm	built-in

sepio commands

References	RLF620X	RLF660X	RLF630X
Command keys	4 keys	4 keys	4 reprogrammable keys
Back-lighting	according to lighting level and when a key is pressed	according to lighting level and when a key is pressed	according to lighting level and when a key or a bell push button is pressed
Access codes	- 1 installer code - 1 master code - 32 user codes	- 1 installer code - 1 master code - up to 32 user codes (according to the number of tags)	- 1 installer code - 1 master code - up to 32 user codes (according to the number of tags)
Indications	vocal and visual indications of system status, alarms, exits and faults		
Use	indoor	indoor	outdoor
Power supply	4.5 V 2.7 Ah power pack - low voltage threshold 3 V - Type C	4.5 V 2.7 Ah power pack - low voltage threshold 3 V - Type C	4.5 V 2.7 Ah power pack - low voltage threshold 3 V - Type C
Battery life	5 years in normal conditions of use	3 years in normal conditions of use	5 years in normal conditions of use (4 years in case of relay card)
Average current consumed	45 µA	90 µA	30 µA
Average humidity rate	5% to 75% without condensation at 25°C possibly varying between 85% & 95% for 30 days over the course of the year	5% to 75% without condensation at 25°C possibly varying between 85% & 95% for 30 days over the course of the year	5% to 75% without condensation at 25°C possibly varying between 85% & 95% for 30 days over the course of the year
Wireless links	TwinBand® 400/800 MHz	TwinBand® 400/800 MHz - 433.050 - 434.790 MHz, 10 mW max. - 868.000 - 868.600 MHz, 25 mW max.	TwinBand® : - 433.050 - 434.790 MHz, 10 mW max. - 868.000 - 868.600 MHz, 25 mW max.
Operating temperature	- 10°C to + 55°C	- 10°C to + 55°C	- 25°C to + 70°C
Tamper protection	opening / removal / access code search		
Degrees of mechanical protection	IP 30	IP 30	IP 54 / IK 07

2 x 4 channel KNX remote control TU444

The TU444 remote allows to control sepio wireless alarm system and tebis quicklink^Q KNX output modules.

It features 4 command keys, each one allocated to one function of the sepio alarm system, and another in the tebis quicklink^Q system.

It can control up to 8 functionalities:

- 4 functions of the sepio wireless alarm system (orange LED)
- 4 functions of the tebis quicklink^Q system (green LED)

One or several buttons can also be configured to launch a scenario, therefore allowing by the press on one single button to control one sepio and one tebis quicklink^Q function at the same time (for example, press the scenario button will turn on the alarm and close the roller shutters.)

Use of the remote

The remote always emit the same kind of function (sepio wireless or tebis), the permanent system is the last or the only system in which the remote has been configured.

A short press (< 2 s) on one of the side push buttons (③) allows to exit the permanent system to temporarily access the other system.

The permanent system switch can be operated by pressing more than 2 s on one of the 2 side push buttons (③)

Key lock mode

In order to avoid accidental press, the user can lock (or unlock) his remote by pressing simultaneously the 2 side push buttons (③).

In locked mode, any press on the keys (②) are ignored and the LED (①) briefly light up in red. No command is emitted.

Factory reset

Press and hold the **cfg** button and release when the LED (①) blink (> 10 s). The LED (①) switches off when the factory reset has been completed. This operation causes the product configuration to be completely erased, whatever its configuration mode.

After a battery change or a factory reset, wait 15 s before proceeding to a configuration.

Product description

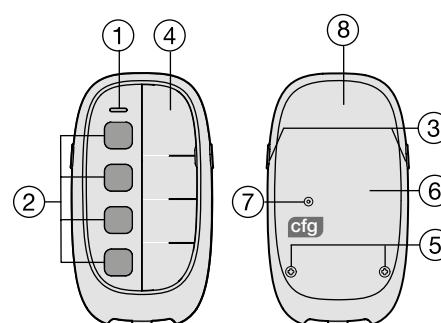

- ① 3-colour signal LED: red, orange, green
- ② Command keys
- ③ Side push buttons
- ④ Labels to indicate functions
- ⑤ Closing screw
- ⑥ Battery cover
- ⑦ Push button **cfg** / Reset
- ⑧ Warranty label

Note

TU444 is not compatible with S781-22X and S791-22X.

sepio intrusion detection

	S161-22F - S162-22X S163-22X - S165-22X	S141-22X	S121-22X	RLA144X	S145-22X
Detection	infrared	infrared	infrared/ hyperfrequency	infrared	
pet detection inhibition	only on S165-22F (see detection diagram)	-	-	yes	yes
Detection area and angle	S161-22F, 12 m - 90° S162-22X, 22 m - 12° S163-22X, 12 m - 8° S165-22X, 12 m - 85°	S141-22F, 10 m - 90°	12 m - 90°	5 settings level from 2.5 to 12 m - 90° Detection setting range 180° (7 positions from A to G)	area adjustable on each side from 2 to 12 m adapted for facade protection
Hyperfrequency range	-	-	range S : 2.45 GHz	-	
Mounting type	bracket, wall, angle	bracket	bracket, wall, angle	wall, pole	wall
Supply	lithium battery 3.6 V, 2 Ah (BATLi38)			lithium battery 3.6 V 4 Ah BATLi05	
Battery life	5 years in normal conditions of use				
Wireless link	TwinBand 400/800 MHz				
Test button	battery/ detection	battery/ detection/ wireless link	battery/ detection	wireless link	battery/ wireless link
LED indicator lamp	1	1	- red : infrared - yellow : hyperfrequency - red + yellow : bi-techno.	LED alarm red or anomaly	2
Operating temperature	-10°C to +55°C -10°C to +40°C (S165-22X)	-25°C to +70°C	-5°C to +55°C	-20°C to +60°C	-20°C to +50°C
Tamper protection	opening/removal (except bracket mounting)	opening	opening/removal	opening/removal	opening
Degrees of mechanical protection	IP 31/IK 04	IP 55/IK 04	IP 31/IK 04	IP 55	IP 55
Dimensions L x l x H	58 x 102 x 57 mm	163 x 85 x 63 mm	125 x 75 x 65 mm	71 x 186 x 106 mm	80 x 198 x 108 mm

sepio intrusion detection

Detection principle S145-22X

The beam is always parallel to the floor
detection

no detection

no detection

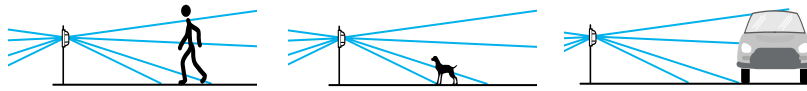

Detection setting S145-22X

position A (12 m)

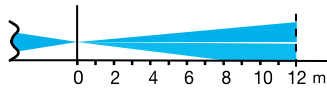

position C (5m)

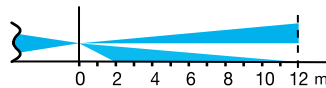

position B (8 m)

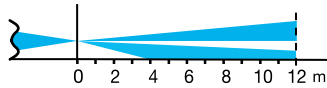

position D (2 m)

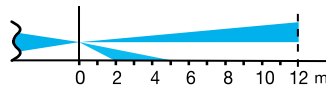

Detection area S145-22X

2 x 2 independently adjustable detection beam,
2 x 12 m range

The beam inclination is
horizontally adjustable at 0 or
30°

approx. 1.4 m
width at 12 m

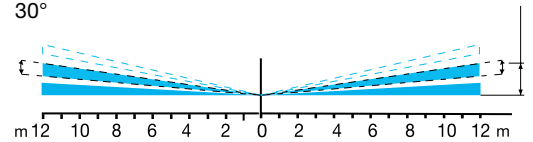

Installing height at 1m

Position of the setting switch	standard detection area (m)	max. detection area (m)
A	12	10 - 15
B	8	6 - 10
C	5	4 - 6
D	2	1.5 - 3

S161-22F 90°

Volumetric protection inside buildings,

- detection area : 12 m,
- horizontal coverage : 90°,
- vertical coverage : 50°,
- number of beams : 19

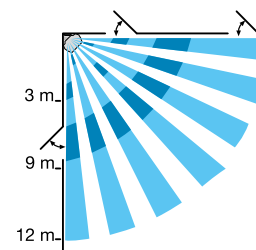
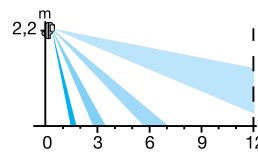

S162-22X corridor

Specific volumetric protection of narrow passages in
housings (entrance, staircase, corridor...).

- detection area : 22 m,
- horizontal coverage : 12°,
- vertical coverage : 55°,
- number of beams : 9

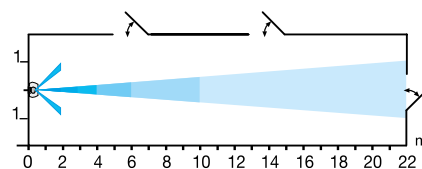
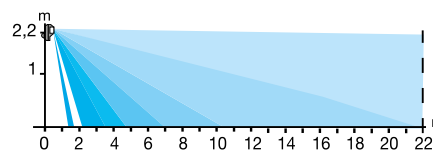

S163-22X curtain

Specific volumetric protection of indoor facades:
window bay, rooms with several doors or perimeter
protection, with or without occupants

- detection area : 12 m,
- horizontal coverage : 8°,
- vertical coverage : 55°,
- number of beams : 19

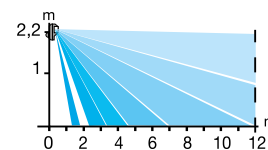
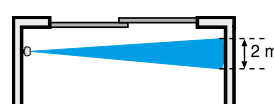

sepio intrusion detection

	Contact detector S261-22F - S262-22F	Multi-contact detectors S271-22F - S272-22F	Roller blinds detectors S231-22X - S236-22X	Glassbreak detector S280-22X
Detection	magnetic contact	magnetic contact	opening contact	acoustic
Couverture	-	-	-	3.65 m/glass : armoured (th. 6.4 mm) 6 m/glass : standard, double, toughened and laminated (thickness 2.4 to 6.4 mm)
Supply	lithium battery 3 V (BATLi31)		lithium battery 3.6 V (BATLi38)	
Battery life	5 years in normal conditions of use			
Wireless link	TwinBand 400/800 MHz			
Test button	battery/detection	battery/detection	programming/battery/ detection	battery/detection
LED Indicator lamp	1	1	1	1/receiver, 1/transmitter
Operating temperature	-10°C to +55°C	-10°C to +55°C	-25°C to +70°C	-10°C to +55°C
Anti-tamper & protection	opening / removal / loop cutting	opening / removal / loop cutting	opening / removal	opening / removal
Degrees of mechanical protection	IP 31/IK 02	IP 31/IK 02	IP 31/IK 04	IP 31/IK 02
Dimensions L x l x H	108 x 26 x 30 mm	138 x 26 x 30 mm	138 x 26 x 30 mm	138 x 40 x 30 mm

S280-22X window bay protection

- protected area, whatever the glass type (including armoured glass)
- protected area, whatever the glass type (excepted armoured glass)
- non protected area

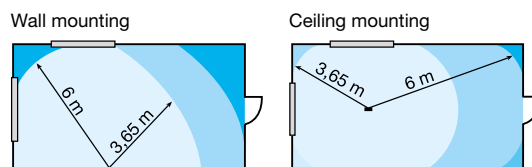

seprio intrusion detection

	RLA176X
Infrared detection	volumetric, 12 m, 85°
Optical field	12 m, 90°
Storage capacity	last 10 10-second sequences
Movie format for reading of the microSD stick on a computer (after intrusion or upon image capture request)	- VGA colour 640 x 480 - 10-second images sequences, 3 images/second
Images format for MMS	- JPEG colour 320 x 240 - 10-second images sequences
Movie format for remote monitoring	10-second movie, 1 image/second
Flash range	up to 7 m at 0 lux
Mounting type	bracket
Use	indoor
Supply	lithium battery BatLi30 - 4.5 V - 3 Ah
Battery life	5 years : 5 image capture (intrusion) per year + 10 sequences of images requests per month
LED Indicator lamp	1
Operating temperature	0°C to +55°C
Tamper protection	opening
Average humidity rate	from 5 % to 75 % without condensation at 25°C
Degrees of mechanical protection	IP 31/ IK 04

RLA176X pet-tolerant IR detector-camera with sending pictures

Detection area

for pets **under** 6 kg

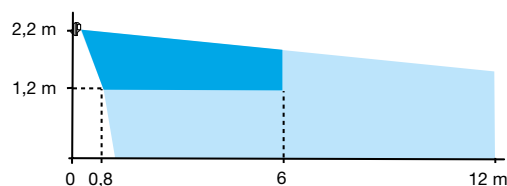

for pets **over** 6 kg

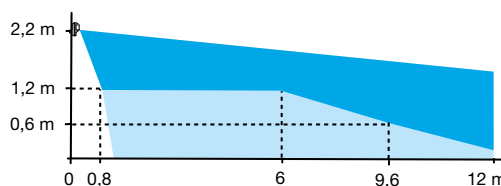

- pet exclusion area
- area authorized to pet

Depending on the room and/or the pet, the mounting height (measured from the center of the detector lens) can be adjusted. When the detector isn't mounted at 2.2 m height from the floor, the limit between detection and non-detection area changes.

Infrared detection

allows rooms protection (living room, bedrooms,...) at a 90° angle for 12 m distance.

Optical field

Corresponds to the built-in camera's field of view at a 90° angle with a range up to 12 m.

NOTE: While capturing pictures in the dark, the range of the flash is limited to 7 m max.

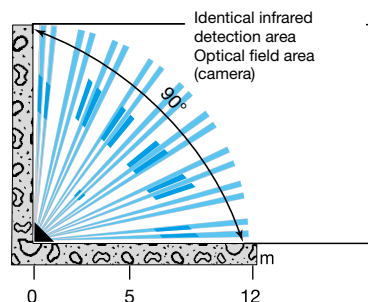

seprio household and fire protection, transmitters

		S232-22X	S233-22X	S234-22X	S235-22X
Detection		freezer temperature	mains supply availability	premise temperature	water damage
Average coverage		-	-	-	-
Sensor detection range and threshold		-12°C	2 s, 18 mn or 5 h without mains connection	triggering : +5°C reclosing : + 7°C	min. : 2 mm
Sensor mounting		placed in the freezer	nesting plug	magnetic base	horizontal/vertical
Supply		lithium battery 3.6 V, 4 Ah (BATLi26) (transmitter)			
Battery life		5 years			
Wireless link		TwinBand 400/800 MHz			
Test button		1 BP (transmitter)			
LED Indicator lamp		1 test light (transmitter)			
Operating temperature	transmitter	-25°C to +70°C			
	sensor	-25°C to +70°C	-5°C to +55°C	-25°C to +70°C	
Tamper protection		case opening			
Degrees of mechanical protection		IP 55/IK 04 (transmitter)			
Dimensions L x l x H	transmitter	130 x 80 x 35 mm			
	sensor	53 x 70 x 12 mm	50 x 70 x 12 mm	53 x 70 x 12 mm	

		S155-22X	S157-22X
Detection		smoke detector	heat and temperature increase speed detector
Average coverage		50 m ²	30 m ²
Sensor detection range and threshold		-	62°C ±8°C
Supply		sealed lithium battery	
Battery life		10 years	
Wireless link		TwinBand 400/800 MHz	
Test button		1 PB luminous halo	
LED Indicator lamp		- red : tripping and programming - yellow : anomaly and normal functioning (1 blink every 10 seconds) luminous halo in case of alert	- red : tripping and programming - yellow : anomaly and normal functioning (1 blink every 10 seconds) luminous halo in case of alert
Built-in signal		> 85 dB to 3 m in detection mode > 75 dB to 3 m (test or anomaly)	> 85 dB to 3 m in detection mode > 75 dB to 3 m (test or anomaly)
Wired interconnection		40 detectors max.	
Operating temperature		-10°C to +55°C	-10°C to +55°C (+ 75°C short period of time)
Degrees of mechanical protection		IP 22	
Dimensions L x l x H		Ø 116 x 49 mm	

		S781-22X	S791-22X	RLE700X
Application	- ON/OFF - timer - presence simulation	- remote control - impulse - system status - intrusion activation		20 peripherals relays (siren and keyboard : 1 product relay) 5 relays max./system Max. number of receivers and/or wireless relays per installation : 10 (ex. 5 receivers and 5 wireless relays / 8 receivers and 2 wireless relays / 10 receivers and 0 wireless relays, etc.)
Supervision	-	-		wireless link/control panel status : battery and tamper protection
Supply	230 V AC	12 - 24 V AC ou DC		2 x (3.6 V-17 Ah) MPU0X - Type C low voltage threshold 3.1 V
Battery life	-	-		5 years
Wireless link				TwindBand 400/800 MHz
Consumption	-	12 V \equiv 22 mA 12 V \sim 24 mA 24 V \equiv 11 mA		-
Output	dry contact NC/NO	dry contact NC/NO		-
Max. load	VLV halogen 12 V 1 500 W incandescent 1000 W	24 V \equiv 1 A 24 V \sim 2 A 12 V \equiv 2 A 12 V \sim 2 A		-
Operating temperature	-20°C to +70°C			-25°C to +70°C
Tamper protection	-			opening / removal
Isolating class	classe II 	-		-
Degrees of mechanical protection	IP 55/IK 04			IP 55/IK 08
Dimensions L x l x H	150 x 85 x 35 mm			240 x 160 x 55 mm

sepio transmitters

Transmitter	RLD454F RLD464F
Supply	
- battery pack (4.5 V - 14 Ah) RXU05X - Type C - Low voltage threshold 3.65 V - or battery pack (4.5 V - 14 Ah) RXU05X and secondary battery Li-Ion (3.7 V 1.3 Ah) RXU03X - or mains power supply module (200-240 VAC 50-60 Hz / 4.5 VDC 2.2 a) RXU01X backed up by battery Li-Ion (3.7 V 1.3 Ah) RXU03X - Low voltage threshold 3,6 V type A -Charging time 20 h at 80 % - 36 h operating life	●
Battery life	
5 years in normal conditions of use	●
Average current consumed	
235 µA	●
Average humidity rate	
from 5 %to 75 % without condensation at 25°C	●
Wireless link	
Wireless TwinBand® : 400/800 MHz	●
General data	
1 built-in programming keyboard	●
1 built-in microphone and 1 built-in speaker for recording and listening	●
2 access codes (installer, user) from 4 to 6 digits programmable	●
Speech synthesis in 6 languages	●
Automatically switch to summer/winter time	●
Max. number of images transmission detectors : 40 max	●
Welcome message personalisation	●
Voice messages to identify the products (with control panel S.I.T.E. card only)	●
Voice personalisation for 4 alarm groups	●
Log of the last 500 dates and time-stamped events	●
Remote control over the phone	PSTN/GSM ⁽¹⁾
Transmission protocols	
PSTN : voice protocol to individual correspondents / FSK 200 bauds and ID contact to remote monitoring companies	PSTN
- GSM : voice/SMS/MMS protocol to individual correspondents / contact ID to remote monitoring companies	- GSM
Transmissions	
- 3 call cycles of 2 or 3 phone numbers, up to 5 call attempts per number in case of no acknowledgement (20 digits max. per number) - 8 programmable phone numbers in case of alarm	●
1 phone number for system correspondent	●
Transmission of the alarm images to the remote monitoring company	●
Transmission up to 5 images JPEG via MMS to individual correspondents	●
Programmable call cycle (beginning and period of 1 minute to 31 days)	●
Digital transmission of switching on/off to a remote monitoring company (and to an individual correspondent via SMS if GSM)	●
Identification number from 1 to 8 digits for an individual correspondent call	PSTN/GSM
Identification number from 4 to 8 digits for a remote monitoring company call	PSTN/GSM-GPRS
Operating temperature	-10 to +55°C
Degrees of protection	IP30 and IK06
Tamper protection	
Against removal or opening	●
Against power cuts, depending on the used media	●
Against communication network cuts (PSTN, GSM interference), depending on the used media	●
Against wireless interference	●
Against fraudulent code search	●
Supervision	
Wireless	●
Battery / mains power module / secondary battery	●
Tamper protection	●

● : available function

⁽¹⁾ GSM, only if transmitter is supplied by mains.

sepio transmitters

The transmitter only operates in an alarm system including the control panel.
It communicates via several communication networks: PSTN - GSM/GPRS

The images transmission detectors convey:
- intrusion events directly to the control panel,
- the recorded images directly to the transmitter.

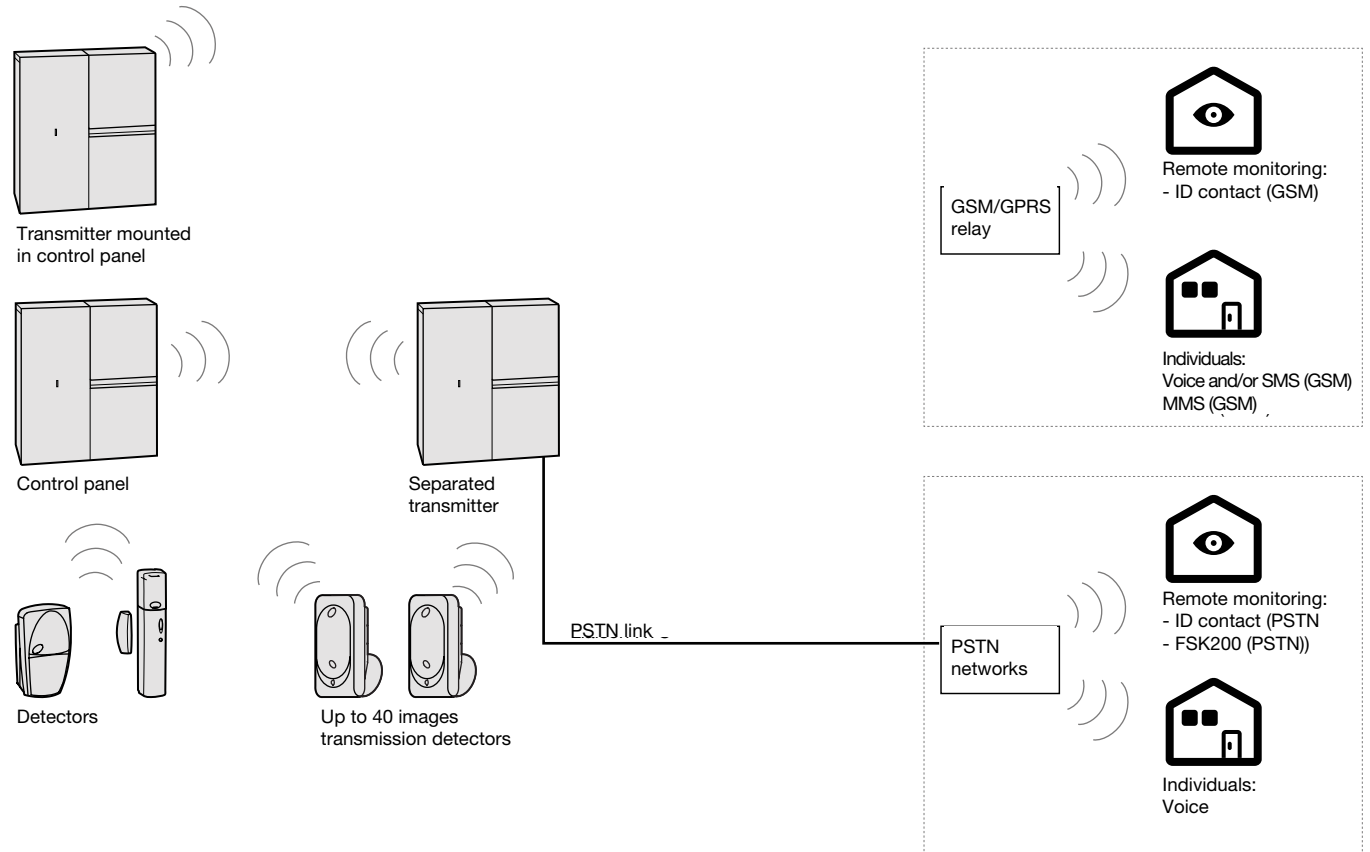

Note : Each images transmission detector must be linked to and identified by the control panel and the separated transmitter.

sepio sirens

	RLD414X	RLD415F / RLD416X
Acoustic level	93 (±2) dB at 1 m	103 (±2) dB at 1 m
Sounding duration	20 s to 180 s	20 s to 180 s
Modulation	3600 Hz to 4200 Hz modulation 6 Hz (internal sounding)	1400 Hz to 1600 Hz (external sounding)
Fire sounding	700/900 Hz, sounding duration : 5 mn	700/900 Hz, sounding duration : 5 mn
Transfer of Arm/Disarm indications	sounding and vocal message	audible
Environment	indoor	outdoor
Power supply	TwinPower® via lithium power pack (2 x 3.6 V) - C type - 3.1 V low voltage	power pack 4 x 1.5 V- C type - 5.01 V low voltage
Battery life	5 years in normal conditions of use	5 years in normal conditions of use
Average current consumed	223 µA	260 µA
Average humidity rate	5% to 75% without condensation at 25°C	5% to 75% without condensation at 25°C
Wireless links	TwinBand® 400/800 MHz	TwinBand® 400/800 MHz
Supervision	radio, power pack, tamper	radio, power pack, tamper
Operating temperature	- 10°C to + 55°C	- 25°C to + 70°C
Tamper protection against	- opening / removal / wireless	
Degrees of mechanical protection	IP 31 / IK 06	IP 54 / IK 08
Flash	-	flash 1 pulse per 2 seconds
Dimensions L x H x P	192 x 192 x 59,9 mm	235 x 256 x 90 mm

Technical characteristics

	TG600A	TG600AL	S155-22X	S157-22X
Type of detection	smoke	smoke	smoke	heat
Power	lithium battery 3 V type CR123A	sealed lithium battery	sealed lithium battery	sealed lithium battery
Average coverage	50 m ²			30 m ²
Battery life	5 years	10 years	10 years	10 years
Indication	rouge : triggering, test and faults		red : triggering and signaling yellow : faults and normal operation (1 flash every 10 s.)	
	-		emergency halo lighting	
Sounding	> 85 dB at 3 m upon detection > 75 dB at 3 m (during testing and fault indication)			
Interconnection	-		wireless via 40 detectors max.	
Operating temperature	- 10 °C to + 65 °C			
IP	IP 30		IP 22	
Connecting socket with relay	-		RXA05X	
Dimensions	Ø 97 x 37 mm		Ø 116 x 49 mm	

S155-22X and/or S157-22X network

Smoke and heat detectors in a network (40 max.)

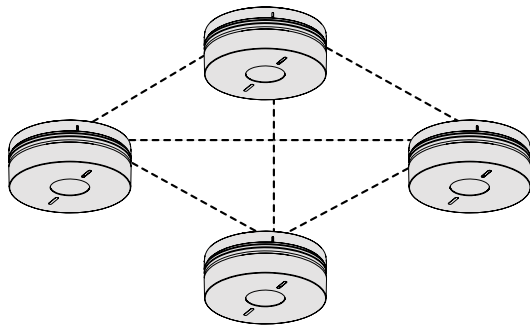

red : triggering and signaling
yellow : faults and normal operation
(1 flash every 10 s.)

Connecting socket with relay

	RXA05X
Use	indoor
Breaking capacity	2 A / 230 V
Connection capacity	rigid : 1 to 1.5 mm ² flexible : 1 to 1.5 mm ² flexible with socket: 1 to 1.5 mm ²
Operating temperature	-10 °C / + 55 °C
Dimensions	Ø 110 x 28 mm
IP	IP 32
Weight	125 gr

The connecting socket with relay is used to create a dry contact in case of an alarm, and therefore to command a lighting, a phone transmitter, etc...

contact relay NO : 2 A - 230 V AC
section 2,5 mm² max.

